



Seating Components

Cushion Product Range

Community Nursing

Postural & Pressure-Relieving Seating

High-performance, Environmentally Friendly
Memory Foams

General Seating Components

QBITUS PRODUCTS IS A LONG-STANDING, RESPONSIBLE, HIGHLY REPUTABLE BUSINESS WITHIN THE HEALTHCARE SECTOR.

QBITUS IS THE UNITED KINGDOM'S LEADING SUPPLIER OF BESPOKE PRESSURE RELIEVING CUSHIONS TO THE NATIONAL HEALTH SERVICE AND THE WIDER COMMUNITY.

CONTENTS

1. Guide to Product Range Symbols	5
2. Community Range	6 – 17
3. Mercury Range	18 – 37
4. Mercury Xtreme Range	38 – 53
5. Q-Care Range	54 – 59
6. Dynamic Range	60 – 73
7. Bespoke & Miscellaneous	74 – 103
8. Instructions for Use & Cleaning	104
9. Direct Healthcare Group	106

* Risk categories are given as a guide and rely on your judgement and experience.

† Weight Guides are a general indication of an ideal user weight to give optimum durability, comfort and performance; it is not a definitive or maximum value. (This product has been tested to 325lb (146kg) without failure).



GUIDE TO PRODUCT RANGE SYMBOLS

The Risk Category symbols contained in our product information correspond with the Waterlow Pressure Ulcer Prevention/ Treatment Policy as detailed. The colour of the different Risk Categories also corresponds with the Purpose T Pressure Ulcer Risk Assessment framework.



20+ Very High Risk Waterlow Score

Suitable for use with patients clinically evaluated to be at Very High Risk of developing pressure damage.



15+ High Risk Waterlow Score

Suitable for use with patients clinically evaluated to be at High Risk of developing pressure damage.



10+ At Risk Waterlow Score

Suitable for use with patients clinically evaluated to be At Risk of developing pressure damage.



Product Risk Categories have been verified by pressure mapping and clinical evaluations performed in conjunction with Professor Keith Harding and Professor Michael Clark at the Welsh Wound Innovation Centre.

DESIGNED FOR COMMUNITY NURSING

COMMUNITY RANGE

The Community range of cushioning was specifically designed with community nursing and practices in mind.

The design brief was to develop a product range where comfort, performance, durability and safety were integral elements to all items.

In the Community range of cushioning, comfort is achieved by using carefully selected materials which are suitable for long-term use, whilst being easy to maintain and hygienic.

The choice of raw materials also enhances the performance, making sure they are appropriate to the risk factor and load bearing qualities of the particular item.

As with every Qbitus product, the design and construction of the Community range ensures high durability, whilst conforming to all present safety regulations.

All relevant care, safety and directional information is included with the product.

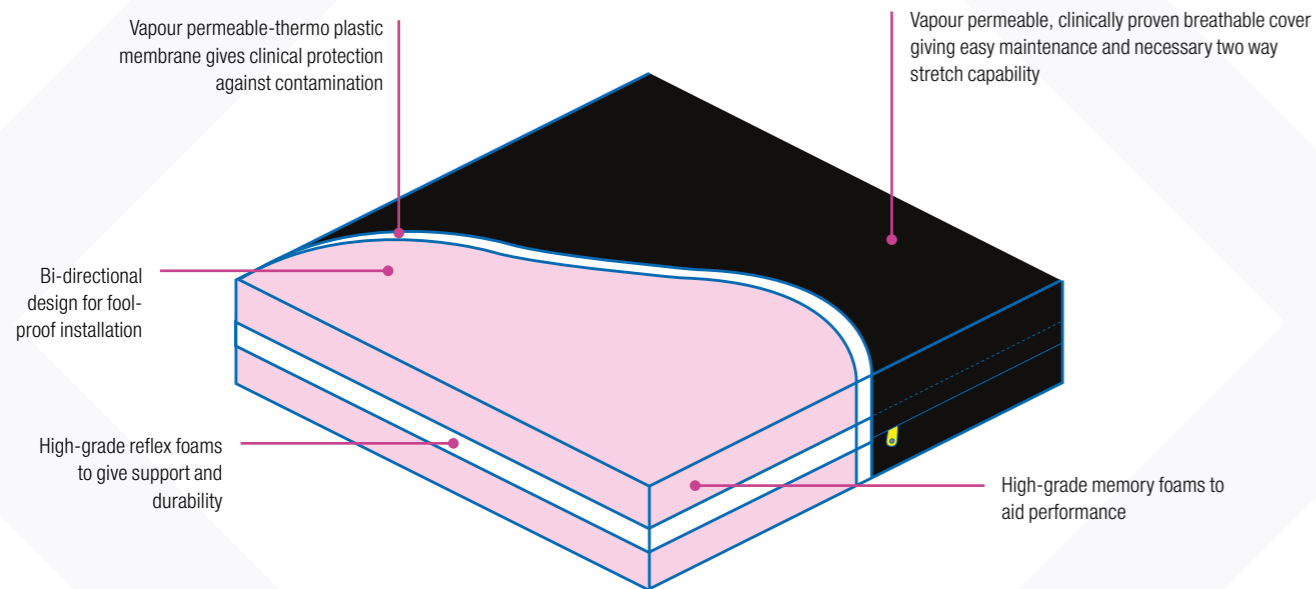

COMMUNITY ONE

The Community One is a special bi-directional cushion constructed in multi-layer format, consisting of both reflex and memory foams. This results in an extremely comfortable and high-performance product with the added bonus of making installation very user friendly.

This product fulfils the design directive for the Community range, ensuring high levels of comfort, performance, durability, and safety.

Sizes:	Up to 18" x 18". All cushions are 3" in thickness. Larger sizes available POA
Cover:	Vapour permeable cover with a concealed heavy duty zip and internal vapour permeable thermo plastic liner
Risk Category*:	High
Weight Guide†:	For maximum comfort, durability and performance the weight guide on a 17" x 17" is 14–15 stone (89–95kg)
Support Pressure:	1 lb per square inch at 50% compression or deflection
Linear Load Limit:	21 stone (133 kg) on a typical 17"x17" cushion
Availability:	Individually or in bulk (bulk prices by negotiation)

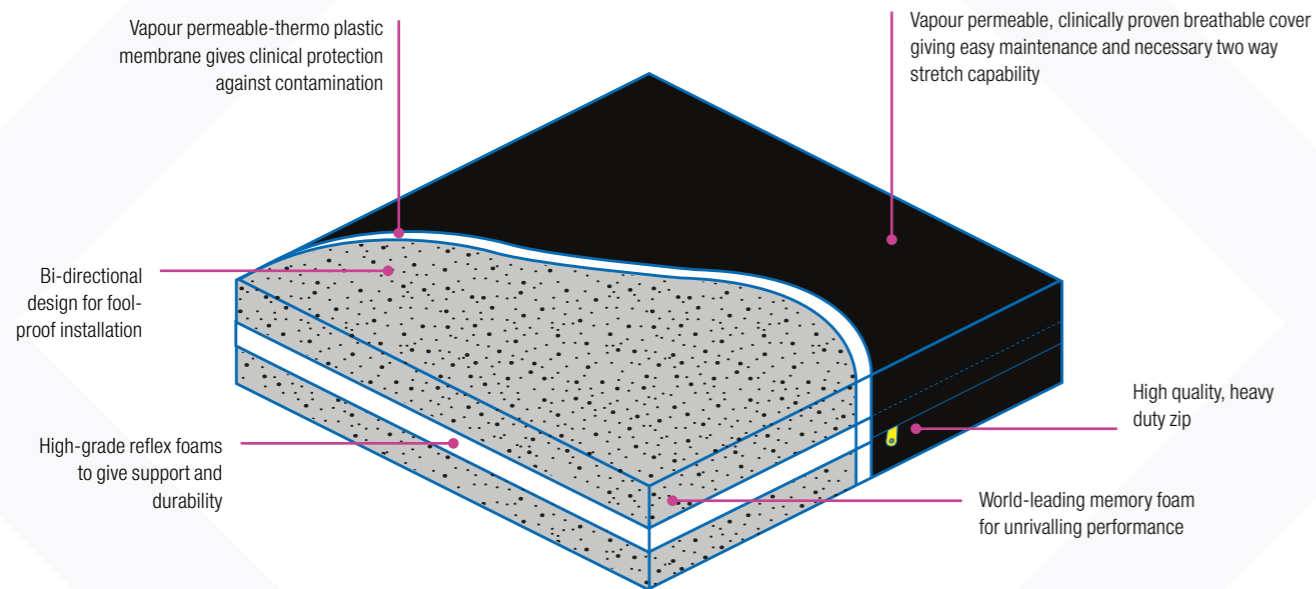

Very High
Risk

COMMUNITY TWO

The Community Two is similar to the Community One in that it is a bi-directional product, constructed in a multi layer format. The cushion uses some of the highest performing memory foams available worldwide, making it one of the finest of its type.

To be considered where increased load bearing and pressure reduction are important; with the added bonus of being almost impossible to install incorrectly. This product fulfils the design directive for the Community range, ensuring high levels of comfort, performance, durability, and safety.

Sizes:	Up to 18" x 18". All cushions are 3" in thickness. Larger sizes available POA
Cover:	Vapour permeable cover complete with concealed heavy duty zip and internal vapour permeable thermo plastic liner membrane
Risk Category*:	Very High
Weight Guide†:	For maximum comfort, durability and performance the weight guide on a 17" x 17" is 18 stone (114kg)
Support Pressure:	1½ lb per square inch at 50% compression or deflection
Linear Load Limit:	31 stone (196kg) on a typical 17"x17" cushion
Availability:	Individually or in bulk (bulk prices by negotiation)

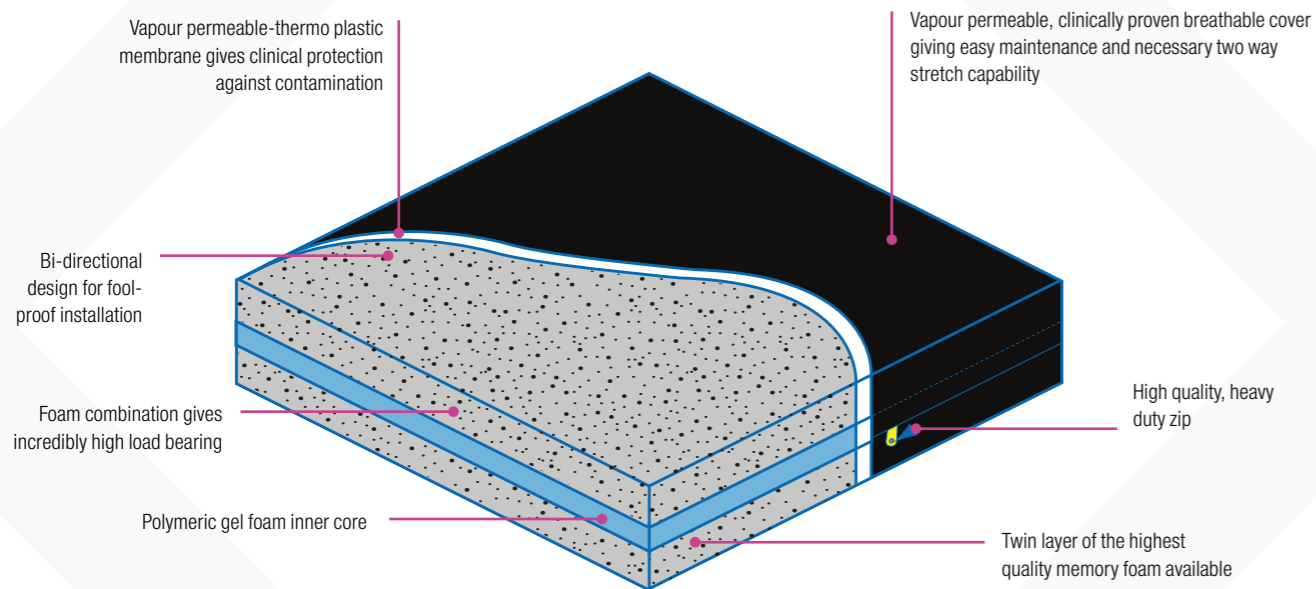

Very High
Risk

COMMUNITY THREE

The Community Three, like the Community One and Two is a bi-directional cushion constructed in a multi layer format.

However, the layers are purely made up from world leading memory foams, the inner core is a polymeric gel foam, its characteristics are unequalled pressure distribution (load spreader) whilst the outer two layers of memory foam have a unique ability to not only spread load but to support load (load bearing).

Unlike almost all other memory foams, both are temperature stable, therefore their characteristics remain constant regardless of extreme temperatures.

The Community Three is able to be installed almost without error or risk to the user. The product goes above and beyond the design directive for the Community range, ensuring excellent levels of comfort, performance, durability, and safety.

Sizes:	Up to 18" x 18". All 3" in thickness unless specified. Larger sizes available POA
Cover:	Vapour permeable cover complete with a concealed heavy duty zip and internal vapour permeable thermo plastic liner
Risk Category*:	Very High
Weight Guide¹:	For maximum comfort, durability and performance the weight guide on a 17" x 17" is 20 stone (127kg)
Support Pressure:	1¾ lbs per square inch at 50% compression or deflection
Linear Load Limit:	34 stone (216kg) on a typical 17"x17" cushion
Availability:	Individually or in bulk (bulk prices by negotiation)

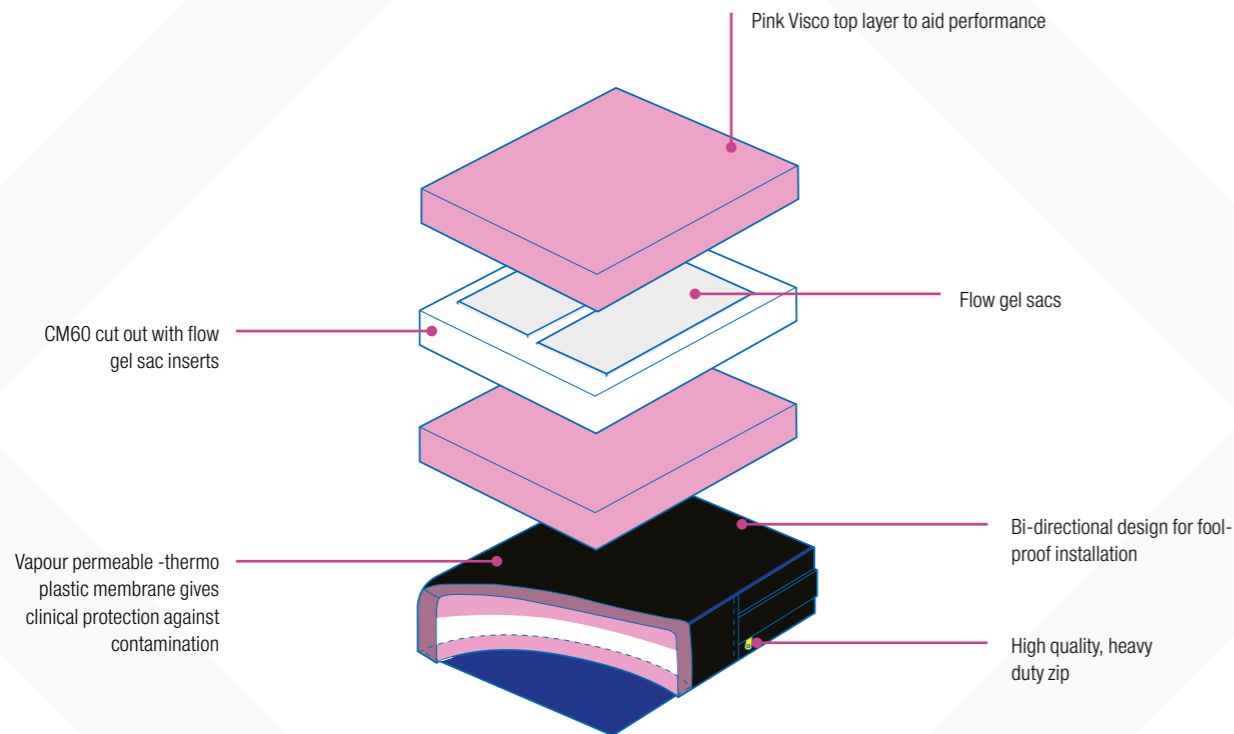

Very High
Risk

COMMUNITY GEL

The Community Gel is a bi-directional product that is almost impossible to fit incorrectly, a major advantage to the busy carer, vulnerable client and concerned clinician.

Utilising UK manufactured high grade memory foam with supporting reflex foam and the integration of the latest ow gel technology, the Community Gel cushion protects, comforts and controls.

Sizes:	Up to 18"x18". All cushions are 3" in thickness. Larger sizes available POA
Cover:	Vapour permeable cover with a concealed heavy duty zip and internal vapour permeable thermo plastic liner
Risk Category*:	Very High
Weight Guide[†]:	For maximum comfort, durability and performance the weight guide on a 17"x17" is 14–15 stone (89–95kg)
Support Pressure:	1lb per square inch at 50% compression or deflection
Linear Load Limit:	21 stone (133kg) on a typical 17"x17" cushion
Availability:	Individually or in bulk (bulk prices by negotiation)

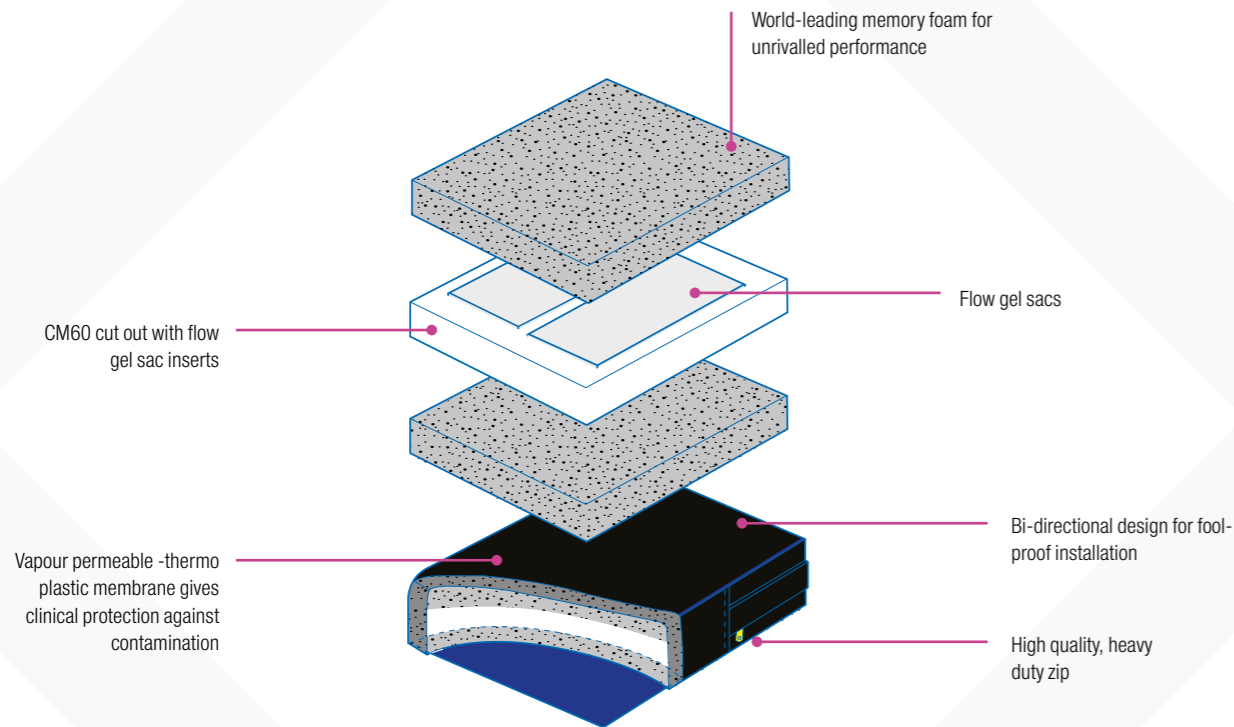

Very High
Risk

COMMUNITY GEL TWO

The Community Gel Two is a bi-directional product making incorrect installation virtually impossible, a major advantage to the busy carer, vulnerable client and concerned clinician.

The Community Gel Two is constructed using some of the world's highest performing and respected memory foam, combined with high grade reflex foam and integrated with the latest flow gel technology, for enhanced load bearing, comfort and performance while contributing to seating stability.

Sizes:	Up to 18"x18". All cushions are 3" in thickness. Larger sizes available POA
Cover:	Vapour permeable cover complete with concealed heavy duty zip and internal vapour permeable thermo plastic liner membrane
Risk Category*:	Very High
Weight Guide†:	For maximum comfort, durability and performance the weight guide on a 17"x17" is 20 stone 127kg
Support Pressure:	1¾ lbs per square inch at 50% compression or deflection
Linear Load Limit:	34 stone (216kg) on a typical 17"x17" cushion
Availability:	Individually or in bulk (bulk prices by negotiation)

POSTURAL AND PRESSURE- RELIEVING SEATING

MERCURY RANGE

The Mercury range of seating components were designed to offer high quality, high performance products at a competitive price, without compromising integrity.

The range consists of products designed for specific types of application, from low risk to high risk, linear designs to seating with posture control, low profile to extreme profile, paediatric to large adult, seat cushioning to backrests.

The Mercury range uses high quality materials from the automotive and furniture industry as well as modern memory foams and gels. Covering materials range from clinically proven breathable stretch materials to new age comfort fabrics.

All the products in the Mercury range come with all relevant technical, care and directional information, which is screen printed on the rear and side of the product.

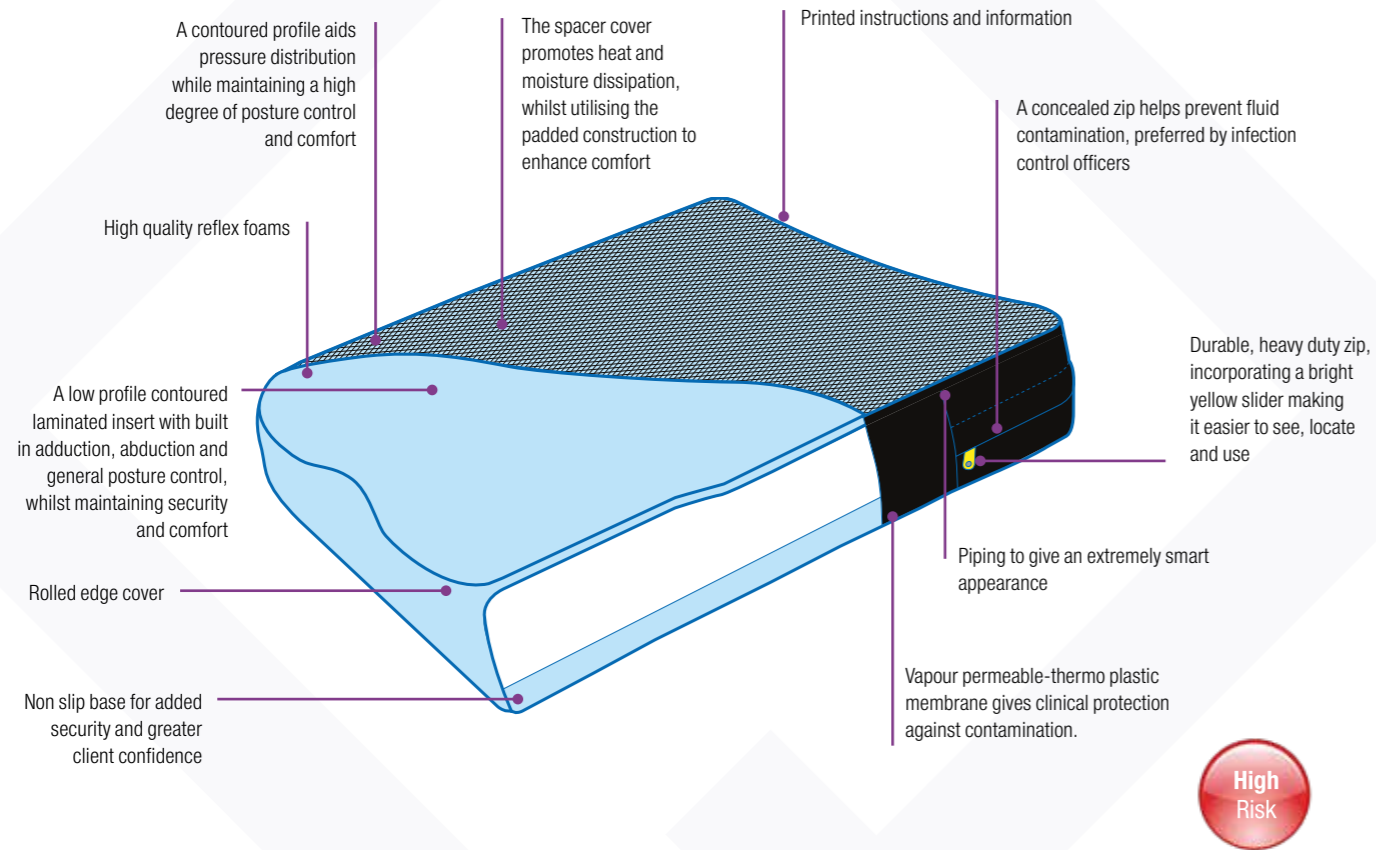

MERCURY JUNIOR

A paediatric positional component, aimed at providing posture control. The Mercury Junior offers long term durability, stability, comfort and support.

Available in either flat or crescent based format with the option of enhanced pressure distribution with the addition of memory foam.

Sizes:	9"x9" to 14"x16". All cushions are 2" in thickness
Cover:	A spacer cover is issued as standard equipment, chosen for its superior heat and moisture dissipation and bringing with it a high degree of comfort, trimmed with piping and vapour permeable side banding, constructed on a non slip base for added security and incorporating a high visibility quality zip and slider, concealed for increased clinical performance. A vapour permeable thermo plastic interliner is included as standard. All relevant technical, directional and care information is clearly printed on the rear of the main cover
Risk Category*:	High
Weight Guide†:	For maximum comfort, durability and performance the weight guide on a 14" x 15" is 10 stone (64kg)
Support Pressure:	1 lb per square inch at 50% compression or deflection
Linear Load Limit:	21 stone (133 kg) on a typical 17"x17" cushion

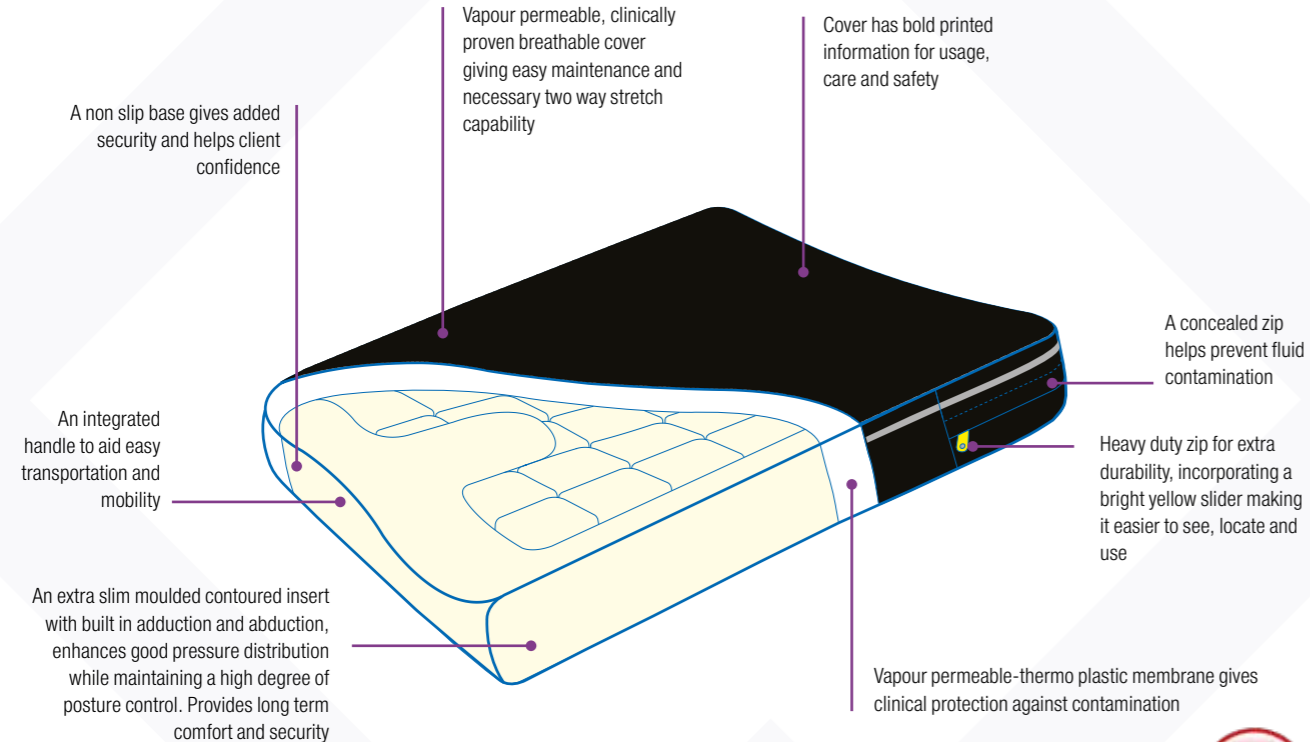

MERCURY 50

An ultra low profile cushion designed for high risk users who may need some degree of posture control without inhibiting the transferral process.

Sizes:	Up to 20" x 18". All cushions are 2" in thickness. Larger sizes available POA
Cover:	The cover is made from a vapour permeable clinically proven material, chosen for its medical performance, durability and ease of use. It is fitted with a heavy duty concealed zip with an easy to reach and use bright yellow slider in a concealed envelope and fitted on a non slip base for added security. All relevant safety, clinical and maintenance information is boldly printed on the rear
Risk Category*:	High
Foam Insert:	A low profile design with integrated adduction and abduction using high grade injection moulded technology, the cold cure foam selected for its durability, comfort and consistent quality
Weight Guide†:	For maximum comfort, durability and performance the weight guide on a 17" x 17" is 15 stone (95kg)
Support Pressure:	1lb per square inch at 50% compression or deflection
Linear Load Limit:	21 stone (133kg) on a typical 17"x17" cushion

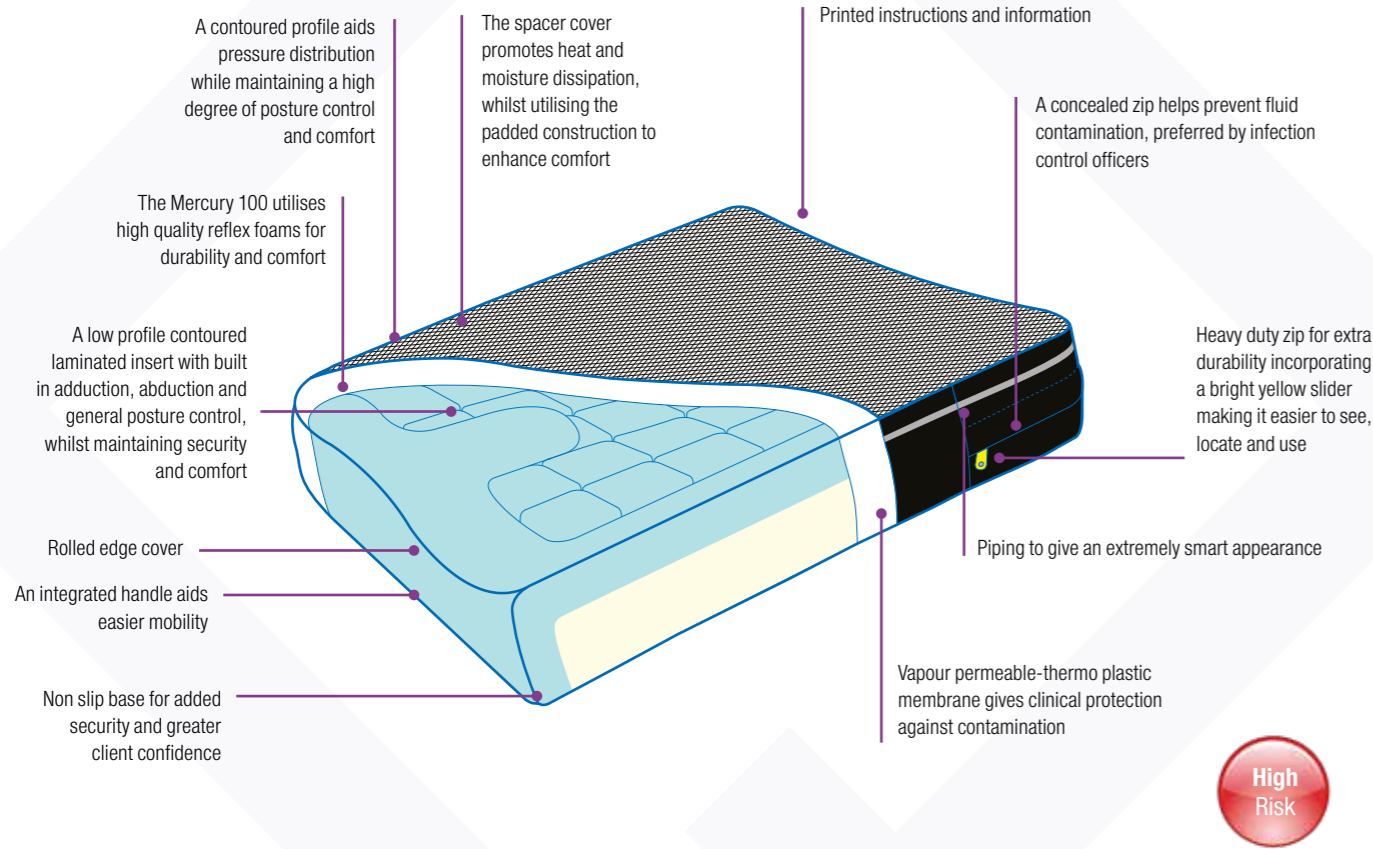

MERCURY 100

A cushion designed for high risk users possibly needing some degree of posture control without inhibiting the transferral process.

- Sizes:** Up to 20"x18". All cushions are 3" in thickness. Larger sizes available POA
- Cover:** A spacer cover is issued as standard equipment, chosen for its superior heat and moisture dissipation and bringing with it a high degree of comfort, trimmed with piping and vapour permeable side banding, constructed on a non slip base for added security and incorporating a high visibility quality zip and slider, concealed for increased clinical performance. A vapour permeable thermo plastic interliner is included as standard. All relevant technical, directional and care information is clearly printed on the rear of the main cover
- Risk Category*:** High
- Foam Insert:** A dual layer low profile moulded and laminated construction using materials chosen for their individual characteristics of durability, posture control, clinical performance and long term comfort and reliability, incorporating built in adduction and abduction and shaped to give maximum surface contact area for an even pressure distribution, inherent in all the Mercury range by design or material
- Weight Guide†:** For maximum comfort, durability and performance the weight guide on a 17" x 17" is 17 – 18 stone (108 – 114kg)
- Support Pressure:** 1½ lbs per square inch at 50% compression or deflection
- Linear Load Limit:** 31 stone (196kg) on a typical 17"x17" cushion

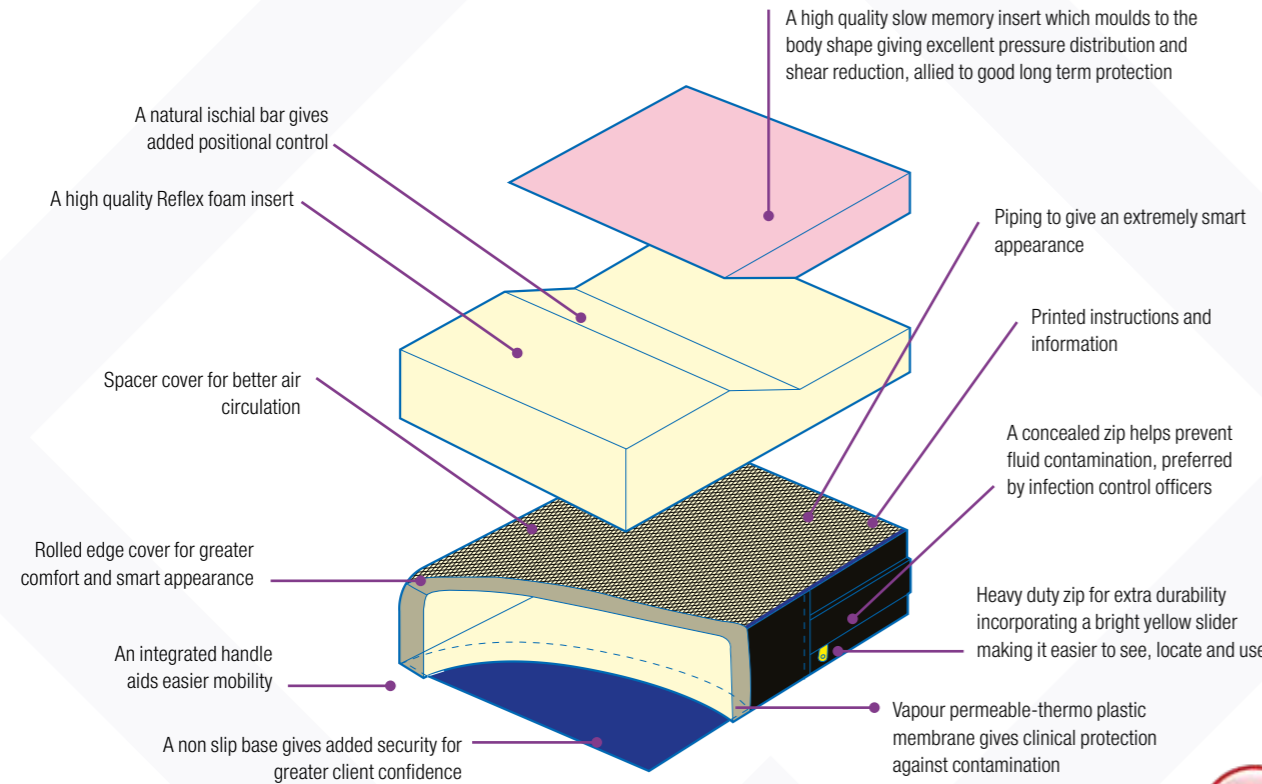

MERCURY 150

Designed to be used for high risk clients using the natural ischial bar to maintain correct positioning and where protection of the I.T. area is required. A long term durable, cost effective item.

- Sizes:** Up to 20" x 18". All cushions are 3" in thickness. Larger sizes available POA
- Cover:** A spacer cover is issued as standard equipment, chosen for its superior air circulation and comfort, trimmed with piping. Vapour permeable sides, constructed on a non slip base for added security and incorporating a high visibility quality zip and slider, concealed for increased clinical performance. Vapour permeable thermo plastic interliner included as standard. All relevant technical and directional information is printed on rear of cover
- Risk Category*:** High
- Foam Insert:** The main body consists of a high quality reflex foam which is both light and comfortable while maintaining the correct support. The addition of a slow memory section in the seating area gives high protection to the I.T. area this design incorporates a natural ischial bar to maintain client security
- Weight Guide†:** For maximum comfort, durability and performance the weight guide on a 17" x 17" is 15–16 stone (95–102kg)
- Support Pressure:** 1½ lb per square inch at 50% compression or deflection (1 lb with modification)
- Linear Load Limit:** 26 stone (164kg) on a typical 17"x17" cushion

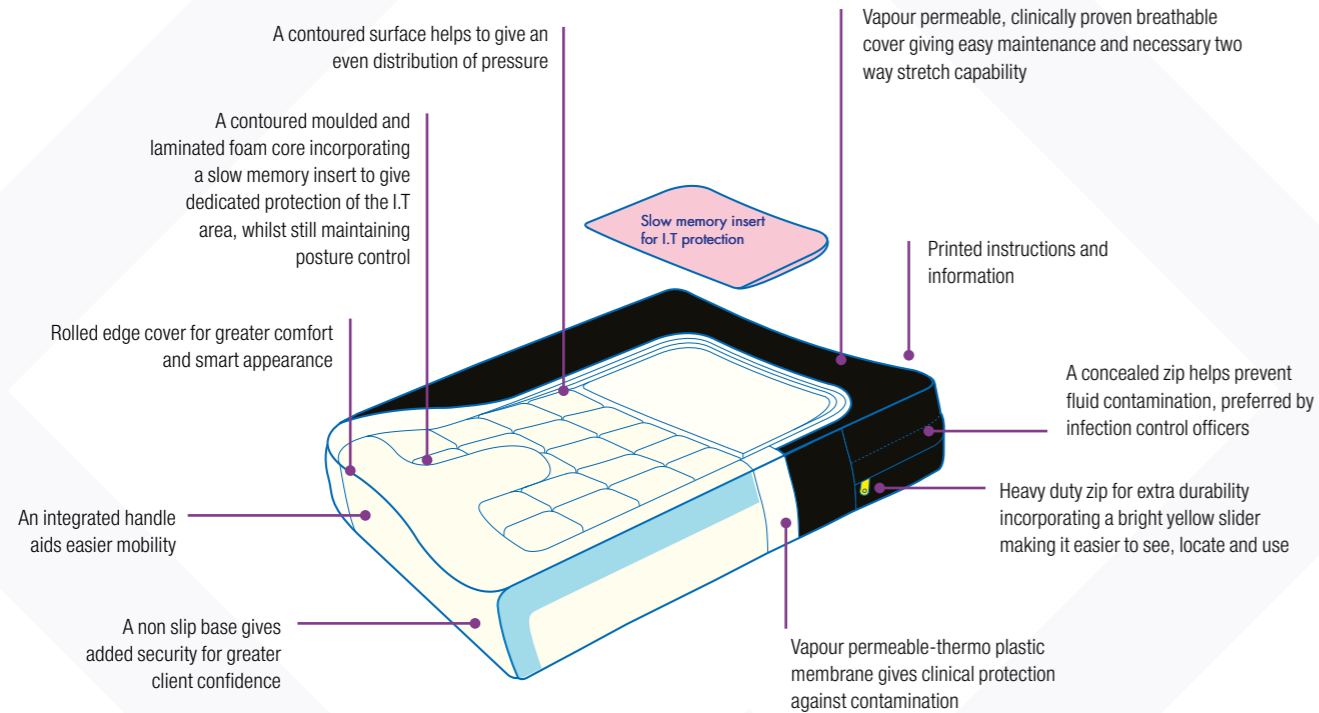

MERCURY 175

To be used where posture control is the main objective but where I.T. protection is a consideration, while still maintaining a relatively low profile.

Sizes:	Up to 20" x 18". All cushions are 3" in thickness. Larger sizes available POA
Cover:	A vapour permeable cover (used for its clinical performance) is issued as standard and comes fitted with a concealed zip, a non slip base and vapour permeable, thermoplastic liner. All relevant technical and directional information is printed on the rear of the cover
Risk Category*:	High
Foam Insert:	A low profile moulded and laminated construction using a triple layer of materials chosen for their individual properties of posture control, durability, clinical performance and long term comfort, whilst giving excellent adduction and abduction. Pressure distribution is further enhanced in the Mercury 175 with the inclusion of a slow memory I.T. pad to give excellent protection of this commonly prone area
Weight Guide†:	For maximum comfort, durability and performance the weight guide on a 17" x 17" is 17–18 stone (108–114kg)
Support Pressure:	1½ lbs per square inch at 50% compression or deflection
Linear Load Limit:	31 stone (196kg) on a typical 17"x17" cushion

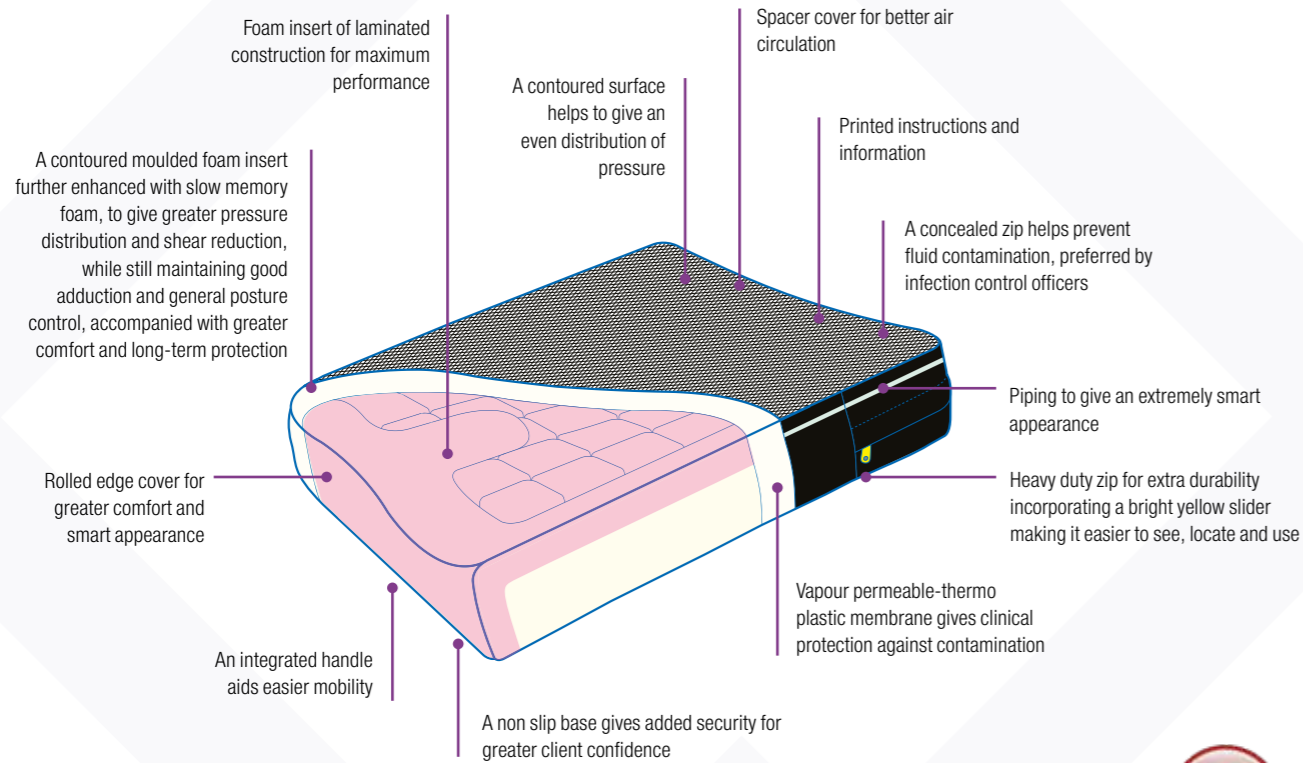

MERCURY 200

Designed where general pressure relief, together with a good degree of posture control, while maintaining a low profile is needed.

- Sizes:** Up to 20"x18". All cushions are 3½" in thickness. Larger sizes available POA
- Cover:** A spacer cover is issued as standard equipment, chosen for its superior air circulation and comfort, trimmed with piping. The sides are vapour permeable, constructed on a non slip base for added security. It incorporates a high visibility quality zip and slider, concealed for increased clinical performance. Vapour permeable thermo plastic interliner included as standard. All relevant technical and directional information is printed on rear of the cover
- Risk Category*:** Very High
- Foam Insert:** A completely new method of construction. Built on a resilient cold cure base to give maximum posture control with great comfort
- Weight Guide†:** For maximum comfort, durability and performance the weight guide on a 17" x 17" is 17–18 stone (108–114kg)
- Support Pressure:** 1½ lbs per square inch at 50% compression or deflection
- Linear Load Limit:** 31 stone (196kg) on a typical 17"x17" cushion

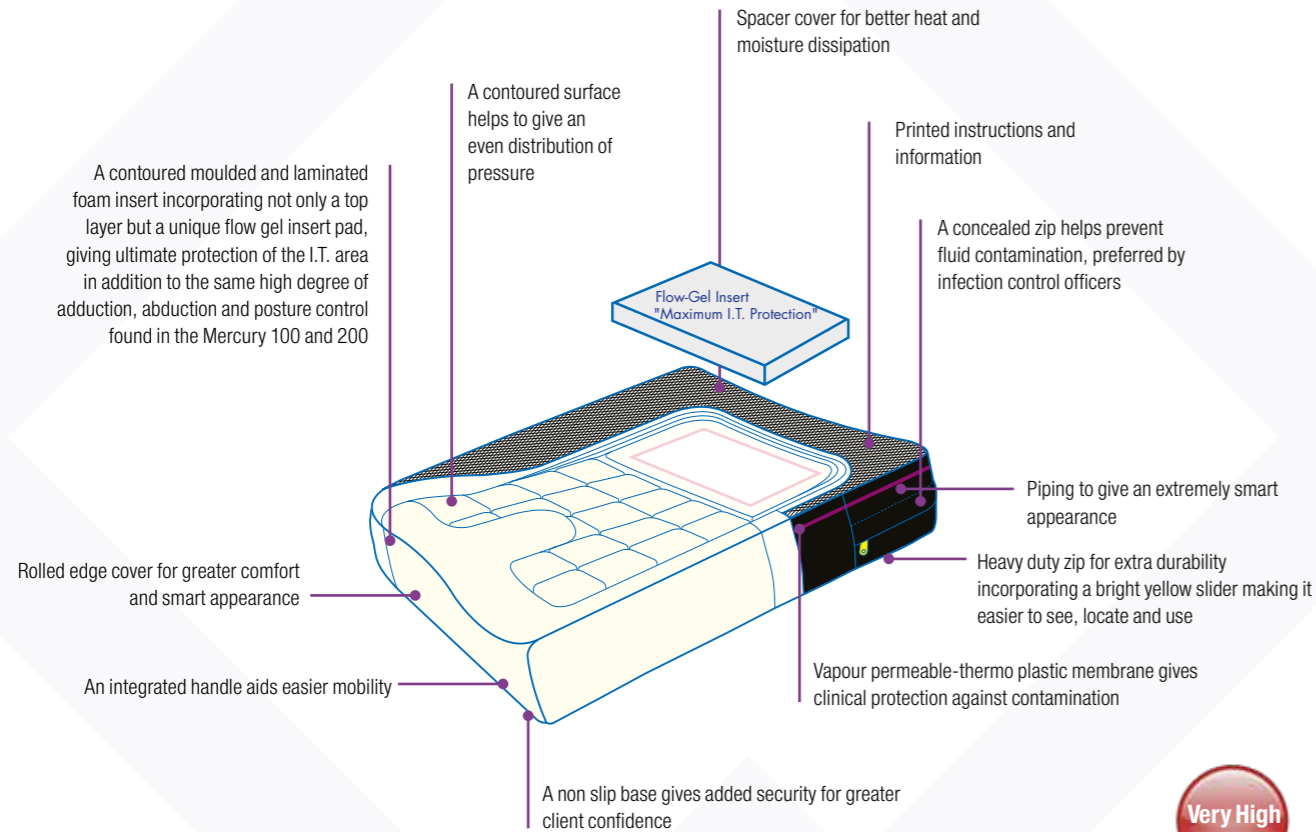

MERCURY 300

A cushion designed for very high risk users, with particular emphasis on the I.T. area, and possibly needing some degree of posture control without inhibiting the transferral process.

- Sizes:** Up to 20"x18". All cushions are 3½" in thickness. Larger sizes available POA
- Cover:** A Spacer cover is issued as standard equipment, chosen for its superior air circulation and comfort, trimmed with piping for smart appearance. The side banding is constructed using vapour permeable material on a non slip base for added security. It incorporates a high quality zip with a highly visible bright yellow slider for easy location and usage, concealed for increased clinical performance. A vapour permeable thermo plastic interliner is included as standard. All relevant safety, care and directional information is printed on the rear of the cover in bold print
- Risk Category*:** Very High
- Foam Insert:** Constructed in a multi layer format with each material chosen for its particular properties: a cold cured foam base for its high resilience, durability and support; a slow memory overlay for its reduction in interface pressure and protection; and particular attention paid to the I.T. area with the inclusion of a flow gel sac or high performance slow memory foam manufactured specifically for this application
All the layers are integrated into a low profile product with built in adduction and abduction
- Weight Guide†:** For maximum comfort, durability and performance the weight guide on a 17" x 17" is 17–18 stone (108–114kg)
- Support Pressure:** 1½ lbs per square inch at 50% compression or deflection
- Linear Load Limit:** 31 stone (196kg) on a typical 17"x17" cushion

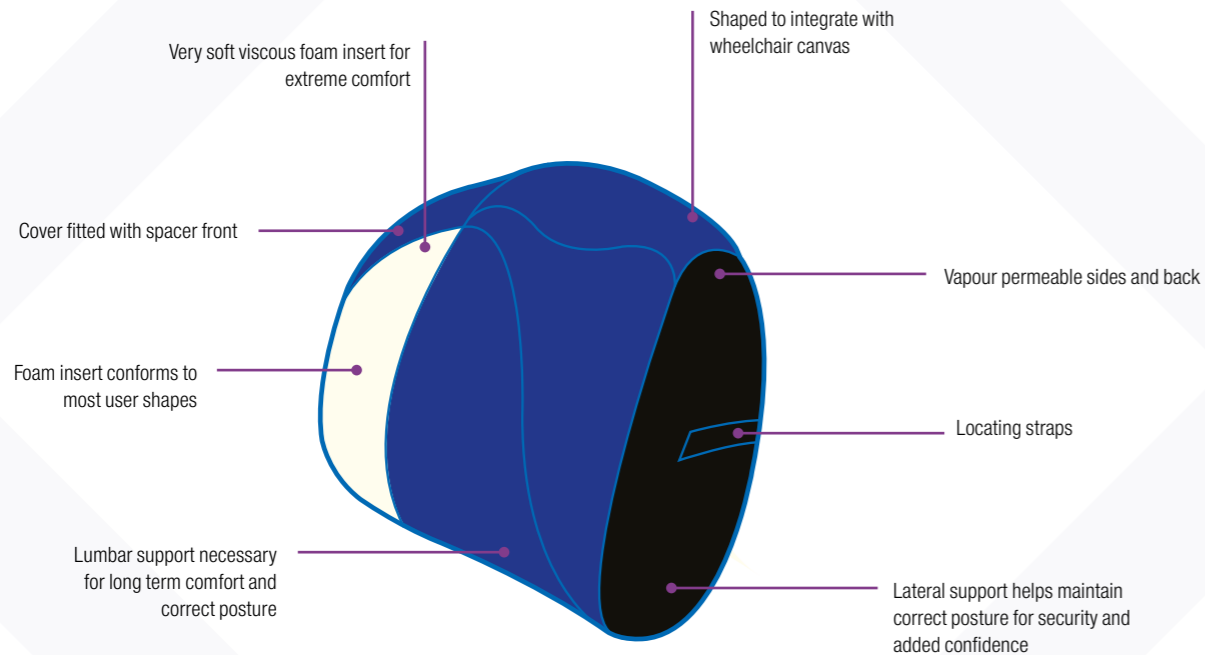

MERCURY POSTURE BACK

Designed to give long term lumbar comfort and lateral support.

- Sizes:** To fit 15", 16", 17" and 18" chair
- Cover:** Finished as standard in a black vapour permeable and spacer cover complete with a concealed heavy duty zip and yellow slider
- Foam Insert:** The Mercury Posture Back foam insert is specially selected for its softness and comfort while still maintaining support and remaining relatively unobtrusive
 Shaped to give lumbar and lateral support for the long term user, while the back of the insert is shaped to accommodate canvas sag – important to help maintain correct posture. Conforms to most shapes

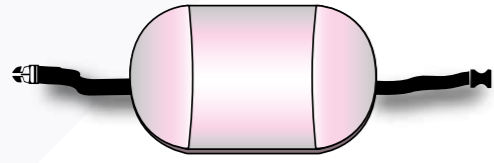

FRONTAL VIEW

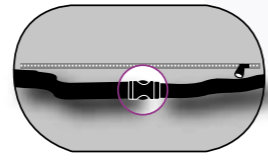

REAR VIEW



Lumbar Pad Cover attached with Quick Release Buckle & Cover

Quick Release Buckles Securely fastens Lumbar support to seating

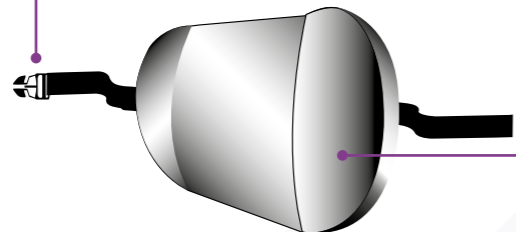
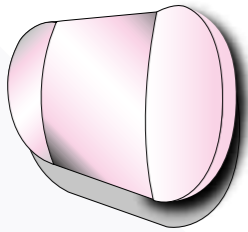

The spacer cover promotes heat and moisture dissipation, whilst utilising the padded construction to enhance comfort

MERCURY LUMBAR PAD

A cost effective product giving long term comfort and support in the lumbar and lateral region.

- Sizes:** To fit 15", 16", 17" and 18" chair
- Cover:** Finished as standard in a black vapour permeable and spacer cover complete with a concealed heavy duty zip and yellow slider
- Foam Insert:** The Mercury Posture Back foam insert is specially selected for its softness and comfort while still maintaining support and remaining relatively unobtrusive
Shaped to give lumbar and lateral support for the long term user, while the back of the insert is shaped to accommodate canvas sag – important to help maintain correct posture. Conforms to most shapes

POSTURAL AND PRESSURE- RELIEVING SEATING

MERCURY XTREME RANGE

Building on the success of the established Mercury Range of cushions, Qbitus Products Ltd have designed and developed the Mercury Xtreme Range..

Where the original version is designed to accommodate transferral procedures and where mobility is essential or desired whilst still providing a high degree of posture control and pressure performance. The Mercury Xtreme range promotes superior posture control, performance, durability and comfort making the Mercury Xtreme range one of the most cost effective choices available today.

MERCURY JUNIOR XTREME

A contoured, multi-layered cushion range giving excellent posture and lateral control by way of fixed adduction, abduction and extended hip guides. Designed to give maximum support, comfort, durability and performance.

Designed for clients up to high risk (with the memory foam insert as an extra cost option), who are in need of a higher degree of posture control than is available with the standard Mercury Junior.

Sizes:	9"x9" to 14"x16". All cushions are 2 1/4 " in thickness in the seating area
Cover:	The cover is constructed from a towelling, two way stretch material chosen for its medical performance, comfort, durability and ease of use. It is fitted with a heavy duty concealed zip with an easy to reach and use bright yellow slider in a concealed envelope. A non slip base and inner vapour permeable liner are added for security and hygiene. All relevant safety, clinical and maintenance information is boldly printed on the rear
Risk Category*:	High
Foam Insert:	Hand fabricated in a combination of high grade, laminated reflex foams, chosen for their specific characteristics, support, comfort, durability and performance. The Mercury Junior Xtreme has the extra cost option of a memory foam insert to protect the IT area for higher risk clients
Weight Guide†:	For maximum comfort, durability and performance the weight guide on a 14"x15" cushion is 10 stone (64kg)
Support Pressure:	1 lb per square inch at 50% compression or deflection
Linear Load Limit:	21 stone (133kg) on a typical 17"x17" cushion

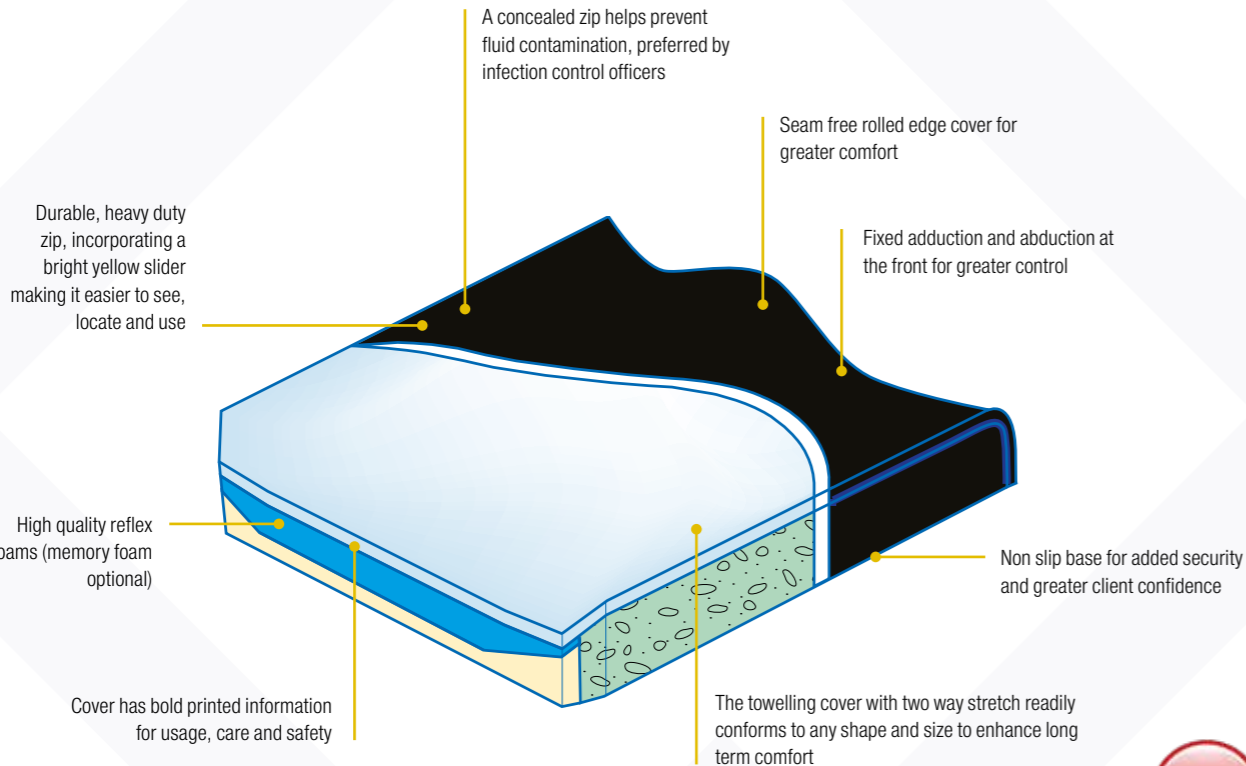

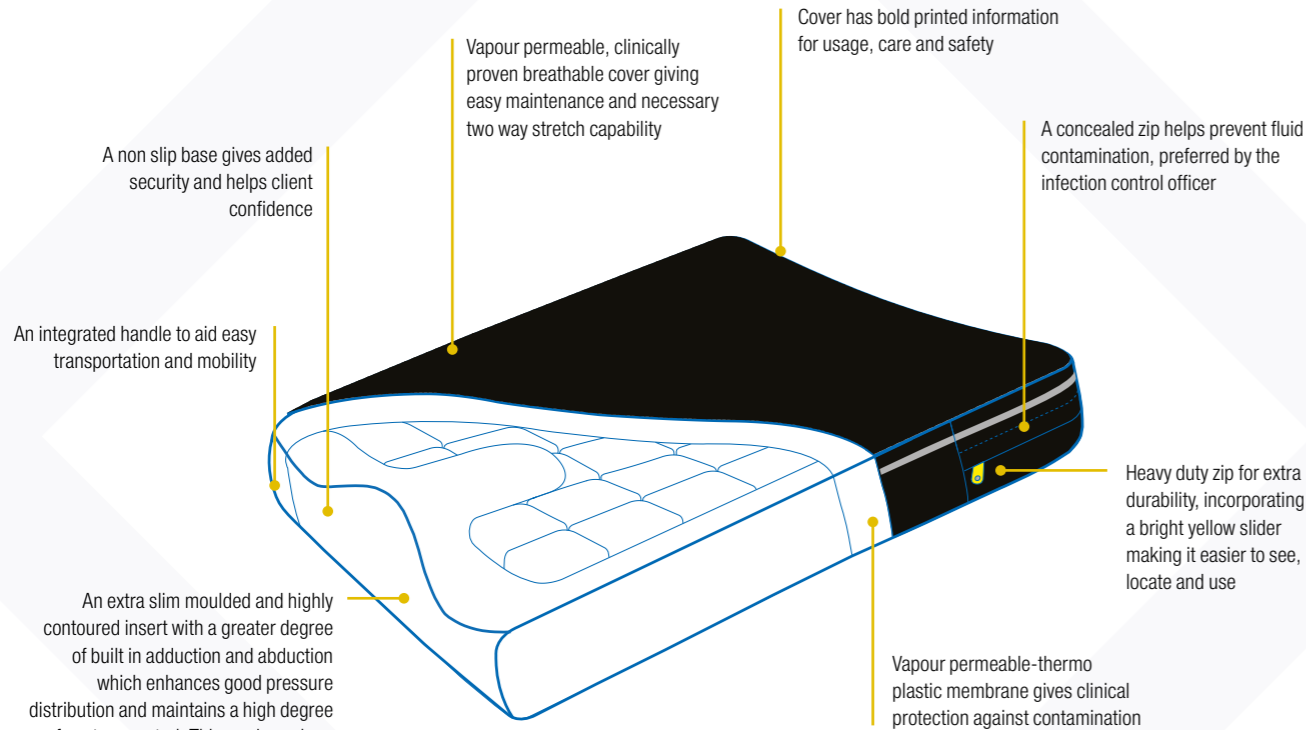

MERCURY 50 XTREME

An ultra low profiled cushion with more aggressive shaping and contouring than the standard Mercury 50, providing excellent pressure distribution for high risk users who require a greater degree of posture control and/or where transferring is not an issue.

Sizes:	Up to 20"x18". Larger sizes are available upon request. Height is approximately 1" in the seating area, (Mercury 100 Xtreme may be an alternative)
Cover:	The cover is constructed from a vapour permeable clinically proven material, chosen for its medical performance, durability and ease of use. It is fitted with a heavy duty concealed zip with an easy to reach and use bright yellow slider in a concealed envelope. A non slip base and inner vapour permeable liner are added for security and hygiene. All relevant safety, clinical and maintenance information is boldly printed on the rear
Risk Category*:	High
Foam Insert:	An extra slim highly contoured, cold cure moulded seat insert with a superior degree of adduction and abduction
Weight Guide†:	For maximum comfort, durability and performance the weight guide on a 17"x17" cushion is 15 stone (95kg)
Support Pressure:	1lb per square inch at 50% compression or deflection
Linear Load Limit:	21 stone (133kg) on a typical 17"x17" cushion

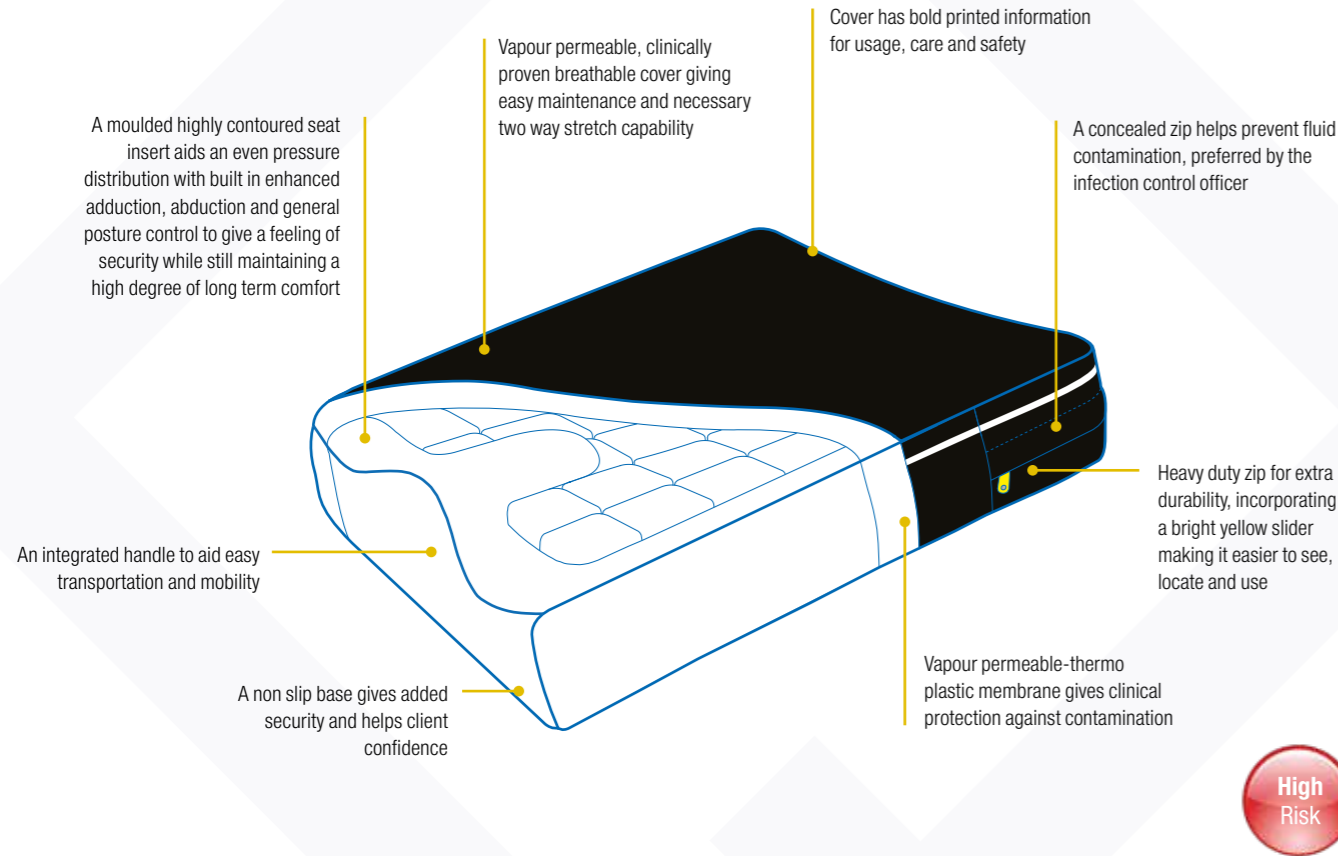

MERCURY 100 XTREME

A seating component with a more aggressively dynamic profile than the standard Mercury 100, designed for high risk users needing a high degree of posture control, incorporating built in adduction and abduction, shaped to enhance the maximum surface contact area for an even pressure distribution and where the self transferral process is not an option or an issue.

- Sizes:** Up to 20"x18". Larger sizes are available upon request. Height is approximately 2" in the seating area
- Cover:** The cover is constructed from a vapour permeable clinically proven material, chosen for its medical performance, durability and ease of use. It is fitted with a heavy duty concealed zip with an easy to reach and use bright yellow slider in a concealed envelope. A non slip base and inner vapour permeable liner are added for security and hygiene. All relevant safety, clinical and maintenance information is boldly printed on the rear
- Risk Category*:** High
- Foam Insert:** A low profile moulded cold cure foam chosen for its characteristics of durability, control, long term comfort and reliability
- Weight Guide†:** For maximum comfort, durability and performance the weight guide on a 17"x17" cushion is 17–18 stone (108–114kg)
- Support Pressure:** 1½" per square inch at 50% compression or deflection
- Linear Load Limit:** 31 stone (196kg) on a typical 17"x17" cushion

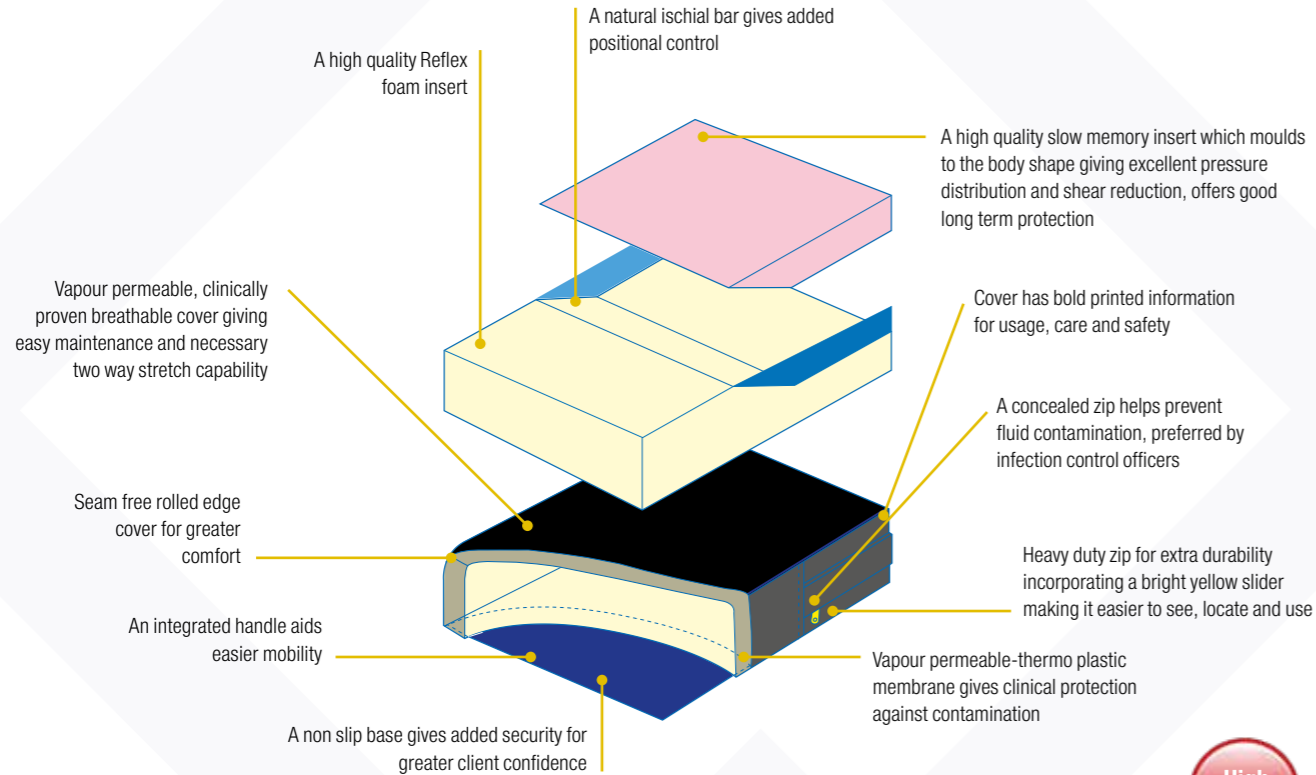

MERCURY 150 XTREME

Designed to be used for high risk clients the Mercury 150 Xtreme uses a high quality reflex foam as a load bearing support base. Shaped to produce a natural Ischial bar to help maintain for and aft positioning.

The side bolsters incorporated within the seating area within the Mercury 150 Xtreme helps to provide superb lateral support, often missing in memory foam seating products. A quality memory foam is located in the seating well to protect the vulnerable I.T. area. An ideal choice for when an aggressive profile is not required.

Sizes:	Up to 20"x18". Larger sizes are available upon request. Height is approximately 3" in the seating area
Cover:	The cover is constructed from a vapour permeable clinically proven material, chosen for its medical performance, durability and ease of use. It is fitted with a heavy duty concealed zip with an easy to reach and use bright yellow slider in a concealed envelope. A non slip base and inner vapour permeable liner are added for security and hygiene. All relevant safety, clinical and maintenance information is boldly printed on the rear
Risk Category*:	High
Foam Insert:	Constructed of a high quality reflex foam base with the addition of memory foam for protection, high load bearing foam for control and a soft finishing foam for comfort
Weight Guide†:	For maximum comfort, durability and performance the weight guide on a 17"x17" cushion is 15–16 stone (95–102kg)
Support Pressure:	1¼ lb per square inch at 50% compression or deflection (1½lb with modification)
Linear Load Limit:	26 stone (164kg) on a typical 17"x17" cushion

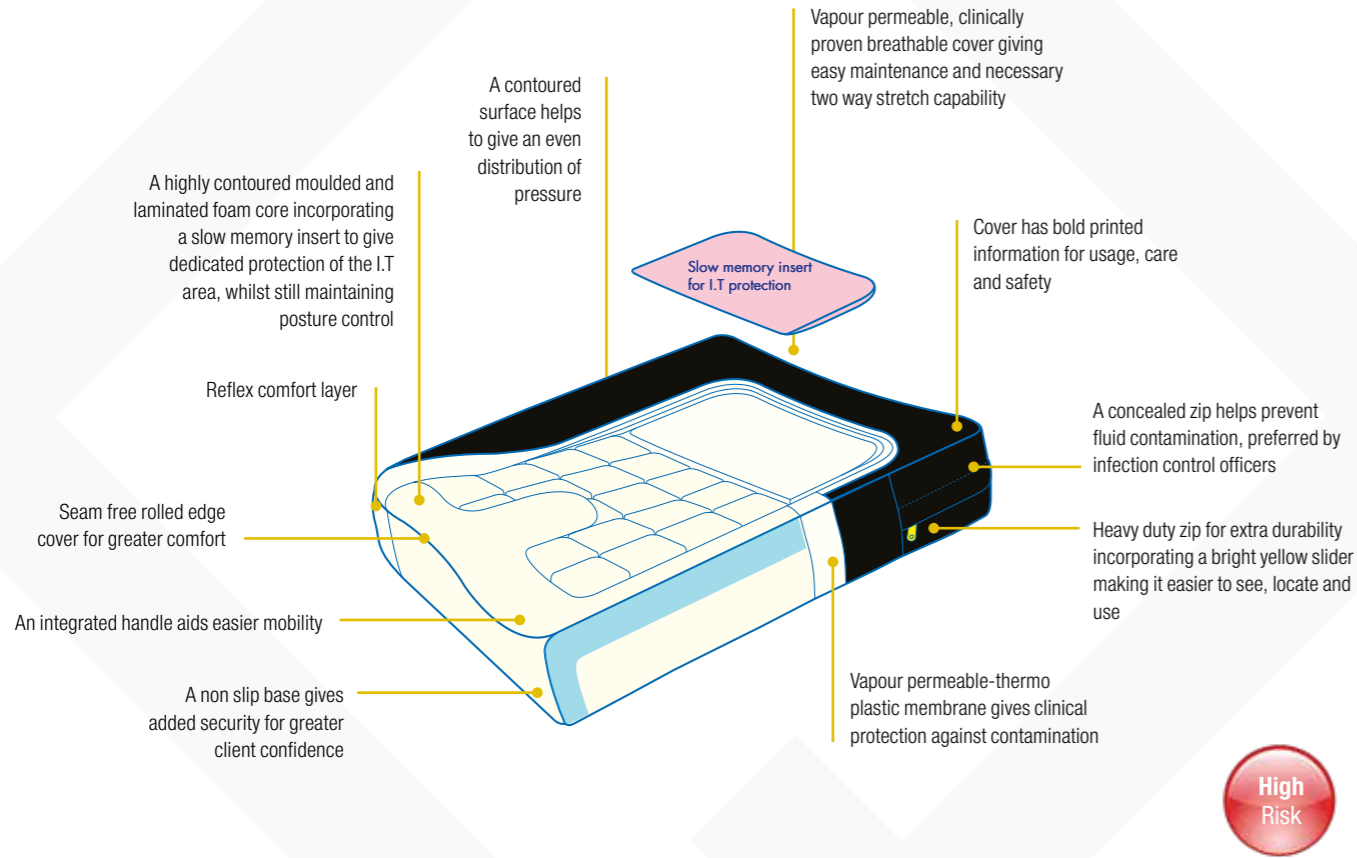

MERCURY 175 XTREME

A highly contoured seating component with a more aggressive profile , adduction and abduction facilities than the standard Mercury 175, to be used for high risk clients where greater protection of the I.T. area is desirable, a need for greater posture control is required and where self transferral is not an option or an issue.

- Sizes:** Up to 20"x18". Larger sizes are available upon request. Height is approximately 3½" in the seating area
- Cover:** The cover is constructed from a vapour permeable clinically proven material, chosen for its medical performance, durability and ease of use. It is fitted with a heavy duty concealed zip with an easy to reach and use bright yellow slider in a concealed envelope. A non slip base and inner vapour permeable liner are added for security and hygiene. All relevant safety, clinical and maintenance information is boldly printed on the rear
- Risk Category*:** High
- Foam Insert:** A low profile insert using a cold cure moulded and laminated construction, incorporating a memory and comfort foam, chosen for their individual properties of posture control, durability, clinical performance and long term comfort
- Weight Guide†:** For maximum comfort, durability and performance the weight guide on a 17"x17" cushion is 17–18 stone (108–114kg)
- Support Pressure:** 1½" per square inch at 50% compression or deflection
- Linear Load Limit:** 31 stone (196kg) on a typical 17"x17" cushion

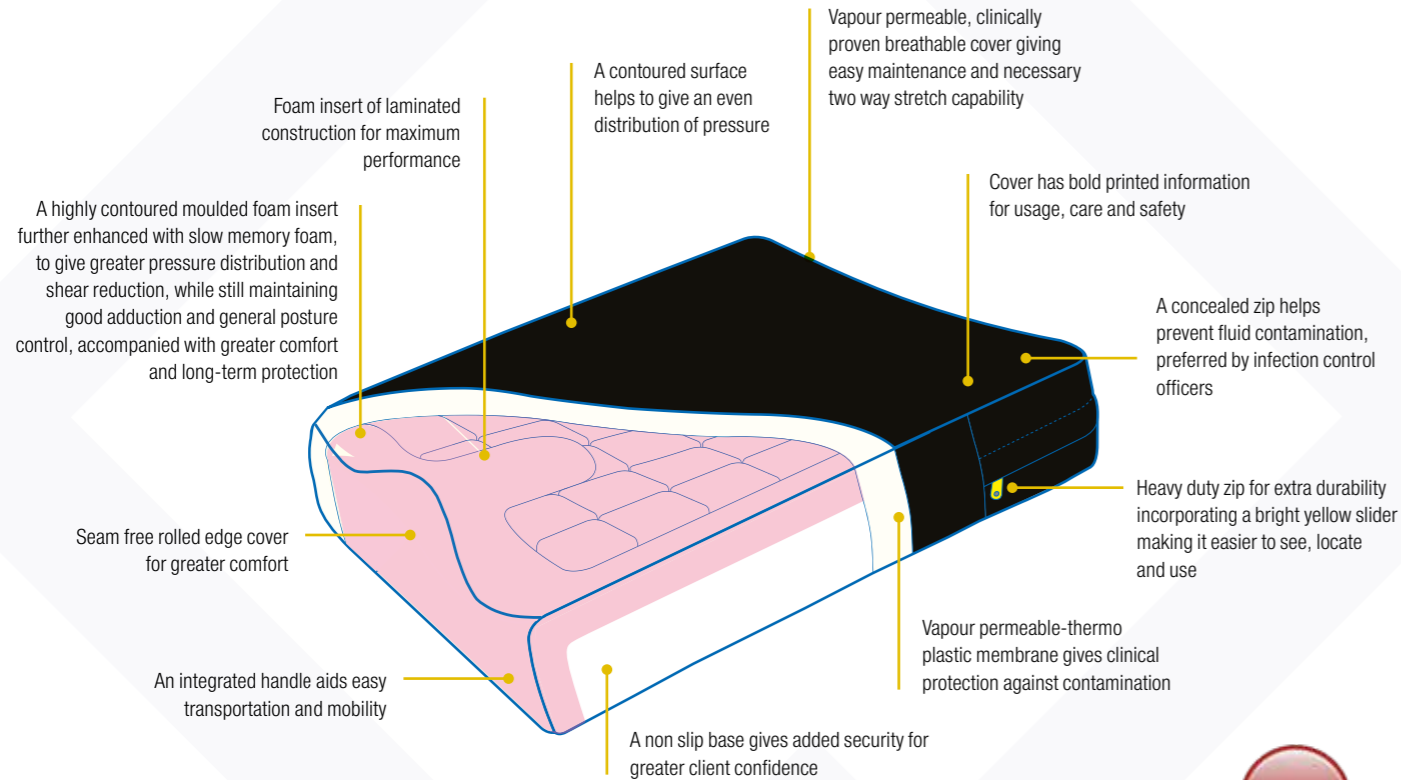

MERCURY 200 XTREME

A highly contoured seating component with a more aggressive profile, adduction and abduction facilities than the standard Mercury 175, to be used for very high risk clients where greater protection of the I.T. area is desirable, a need for greater posture control is required and where self transferral is not an option or an issue.

- Sizes:** Up to 20"x18". Larger sizes are available upon request. Height is approximately 3½" in the seating area
- Cover:** The cover is constructed from a vapour permeable clinically proven material, chosen for its medical performance, durability and ease of use. It is fitted with a heavy duty concealed zip with an easy to reach and use bright yellow slider in a concealed envelope. A non slip base and inner vapour permeable liner are added for security and hygiene. All relevant safety, clinical and maintenance information is boldly printed on the rear
- Risk Category*:** Very High
- Foam Insert:** A low profile insert using a cold cure moulded and laminated construction, incorporating a memory and comfort foam, chosen for their individual properties of posture control, durability, clinical performance and long term comfort
- Weight Guide†:** For maximum comfort, durability and performance the weight guide on a 17"x17" cushion is 17–18 stone (108–114kg)
- Support Pressure:** 1½" per square inch at 50% compression or deflection
- Linear Load Limit:** 31 stone (196kg) on a typical 17"x17" cushion

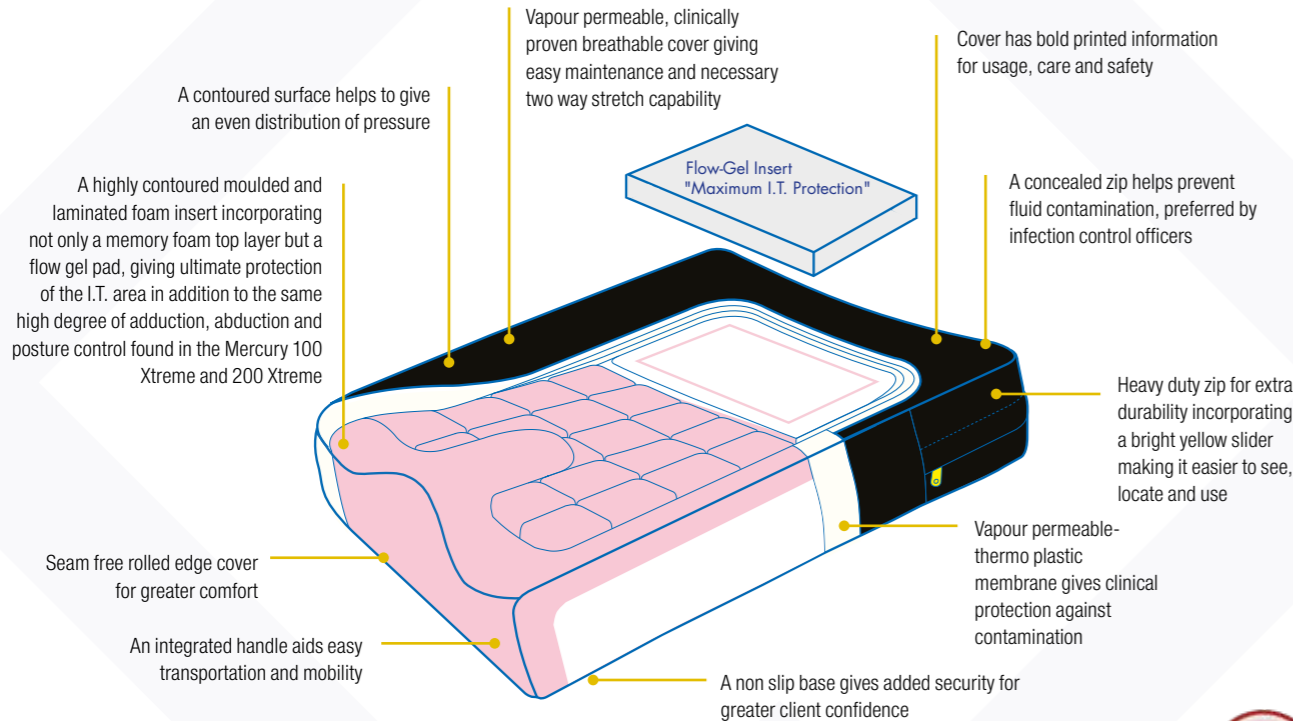

Very High Risk

MERCURY 300 XTREME

A highly contoured seating component designed for very high risk clients with particular attention given to the I.T. area and positional requirements. Combining a highly durable base for control and security, integrated with memory foam and flow-gel technology resulting in an extremely effective high risk component.

- Sizes:** Up to 20"x18". Larger sizes are available upon request. Height is approximately 3½" in the seating area
- Cover:** The cover is constructed from a vapour permeable clinically proven material, chosen for its medical performance, durability and ease of use. It is fitted with a heavy duty concealed zip with an easy to reach and use bright yellow slider in a concealed envelope. A non slip base and inner vapour permeable liner are added for security and hygiene. All relevant safety, clinical and maintenance information is boldly printed on the rear
- Risk Category*:** Very High
- Foam Insert:** A low profile seating component using a cold cure moulded and laminated construction, incorporating memory foam and a flow gel insert, chosen for their individual properties of posture control, durability, clinical performance and long term comfort
- Weight Guide†:** For maximum comfort, durability and performance the weight guide on a 17"x17" cushion is 17–18 stone (108–114kg)
- Support Pressure:** 1½" per square inch at 50% compression or deflection
- Linear Load Limit:** 31 stone (196kg) on a typical 17"x17" cushion

POSTURAL AND PRESSURE-RELIEVING SEATING

Q-CARE RANGE

A new range of high performance seating components based on the original and highly regarded Q-care cushion.

Now released in two different styles and with an option of two different choices to suit your clients needs: high-very high risk with posture control, and medium-high risk with posture control.

The expansion of the Original Q-care concept where adduction and abduction could be added, omitted or adjusted where necessary and includes versions to cover lower risk categories (low and medium) while still providing the same degree of lateral support and the option of including either abduction or adduction by way of a Velcro fastening system as the original.

The new addition to the Q-care range known as the "Q-care Integra" again covers the three main categories of risk, (low-medium-high) but includes or integrates adduction and abduction as standard.

The new Integra 1 has all the control of the higher performing Integra 2 but uses high quality foams used for their reliability, comfort and durability with pressure distribution gained through the reflex shaping of the product, posture control is to the same standard as Integra 2.

The Integra 2 takes the initial concept to the next level by installing one of the highest performing memory foams available, Sunmate, located in the seating well. Further protecting the very sensitive and prone areas such as the I.T's while maintaining supreme comfort and lightness in weight.

All common standard sizes are available (15"x16", 16"x16", 17"x17", 18"x16", 18"x17" and 18"x18"). Most custom or special sizes along with individual client needs are readily available.

Loading on this product is typically 1 1/3lbs per square inch (Q-care1, Q-care 2 and Q-care Integra 1) (Q-care Integra 2 is 1 1/2lbs per square inch) at 50% deflection or compression.

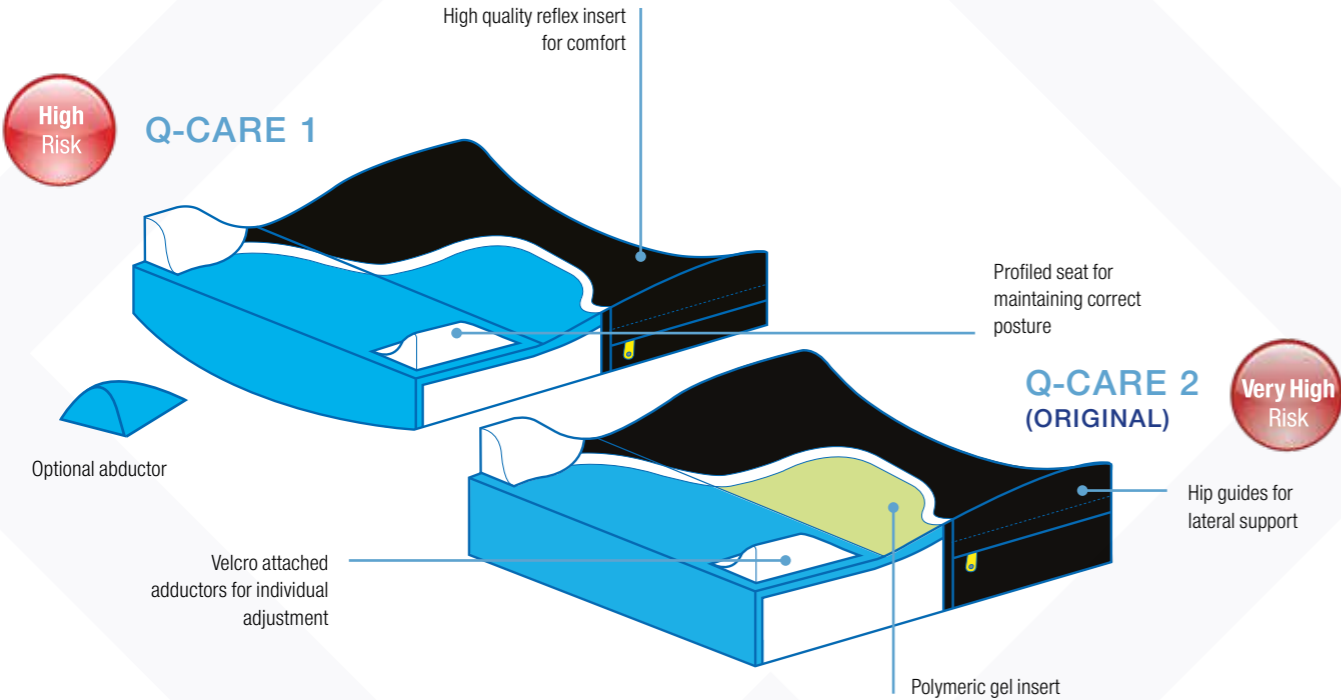

Q-CARE 1 & Q-CARE 2

A new range of high performance seating components, based on the original and highly regarded Q-Care cushion. A contoured, multi-layered cushion range giving excellent posture control and adduction (optional abduction), lateral control and integrated IT bar for added security. Offered in a choice of foams and styles to suit your clients needs.

Sizes:	Up to 18" x 18". All cushions are 3" in thickness. Larger sizes available POA
Cover:	Supplied as standard with a vapour permeable cover with integrated non slip base, with towelling material as an option. Inner vapour permeable liner included as standard. All relevant cleaning, safety, technical and installation information printed on rear of cover
Risk Category*:	Q-Care 1: High Q-Care 2 (Original): Very High
Foam Insert:	Q-Care cushions are constructed of three layers. Firstly a base of CM65 load bearing foam, then a seat well of RX39 (Q-Care 1) or Pudgee polymeric gel foam (Q-Care 2); with a top layer of RX39, for finish and integration
Weight Guide†:	For maximum comfort, durability and performance the weight guide on a 17"x17" for both versions is 16 Stone (102kg). The addition of a 1" crescent base increases the load bearing by 30%
Support Pressure:	1 1/3 lbs per square inch at 50% compression or deflection
Linear Load Limit:	29 stone (184kg) on a typical 17"x17" cushion

Very High Risk

Q-CARE INTEGRA 1

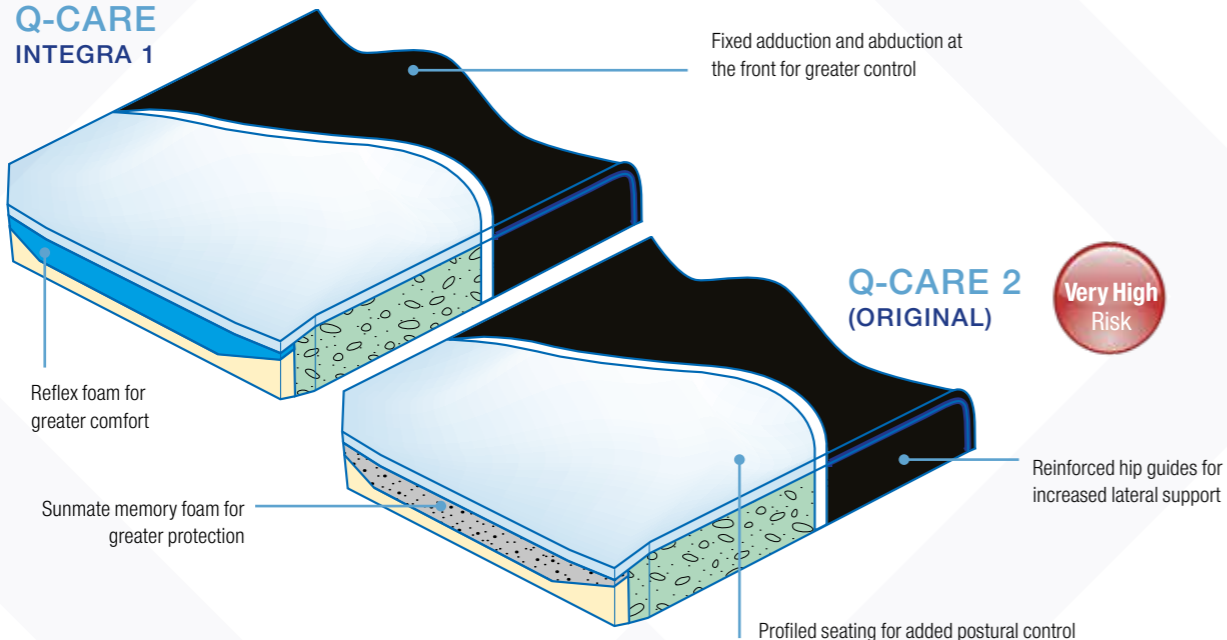

Q-CARE 2 (ORIGINAL)

Very High Risk

Q-CARE INTEGRA 1 & 2

A contoured, multi-layered cushion range giving excellent posture and lateral control by way of fixed adduction, abduction and extended hip guides. Offered in a choice of foams for different levels of protection (Q-Care Integra 1 – very high, Q-Care Integra 2 – very high) to suit your clients needs.

Sizes:	Up to 18" x 18". All cushions are 2" in thickness in the seat well. Larger sizes available POA
Cover:	Supplied as standard with a vapour permeable cover with integrated non slip base, with towelling material as an option. Inner vapour permeable liner included as standard. All relevant cleaning, safety, technical and installation information printed on rear of cover
Risk Category*:	Q-Care Integra 1: Very High Q-Care Integra 2: Very High
Foam Insert:	Laminated in construction, the base layer is CM65, a load bearing foam. The seat well is RX39 (Q-Care Integra 1) or Sunmate memory foam (Q-Care Integra 2). A dense side support foam is used for increased lateral control, and both models are finished with a layer of RX39 for added comfort
Weight Guide†:	For maximum comfort, durability and performance the weight guide on a 17"x17" is: Q-Care Integra 1: 16 Stone (102kg) / Q-Care Integra 2: 18 Stone (114kg). The addition of a 1" crescent base increases the load bearing by 30%
Support Pressure:	Q-Care Integra 1: 1 1/3 lbs per square inch at 50% compression or deflection Q-Care Integra 2: 1 lbs per square inch at 50% compression or deflection
Linear Load Limit:	Q-Care Integra 1: 29 stone (184kg) on a typical 17"x17" cushion Q-Care Integra 2: 31 stone (197kg) on a typical 17"x17" cushion

HIGH-PERFORMANCE, ENVIRONMENTALLY FRIENDLY MEMORY FOAMS

DYNAMIC RANGE

Dynamic Systems range of seating components consists of the most advanced memory foams available in the world today. These represent the latest generation of memory foams, and are manufactured by the company founded by one of the NASA engineers who invented the concept (Tempur Foam), which is now emulated by other manufacturers worldwide.

While other memory foams are marketed under the visco-elastic or thermo-reactive banner as a selling point, the truth is exactly the opposite. While the original Tempur Foam fudged the law of “for every action there is an equal and opposite reaction”, the greatest flaw was the material’s characteristic viscosity which in some cases, changed dramatically with small changes in ambient temperature. In common terms, this means that a cushion made of viscoelastic foam can literally feel like polystyrene at one temperature and a super-soft, non-supporting product at other temperatures; meaning the product you issue in the morning is a different product by lunchtime, or the product you issue in July is not the same item in January.

The safety implications of this are both obvious and serious. They are, however, avoidable by choosing any one of Dynamic Systems’ products. Whether you select Sunmate, Pudgee, or Laminar, you can be assured that due to its viscous stability, the quality and performance of the product you issue is the quality product the client receives.

One of memory foam’s weaknesses is its inability to take high loads. This is particularly evident if you are trying to use a foam product which is comfortable to the user and at the same time supportive. Usually, this is achieved with a combination of various layers of different hardness, or the marriage of two ordinary Reflex furniture foams. As a general rule, memory foam is a “load spreader” and not a “load bearer.”

Dynamic Systems, Inc. recognized these weaknesses in the original materials (amongst others) and developed unique foams to overcome these weaknesses. Two types of memory foam that defeat the general rule are Sunmate and Laminar. Unusual to memory foams, both these foams are high-load-bearing. Sunmate succeeds in achieving this while remaining both light and soft to the touch. Laminar, while being heavy in weight, can sustain virtually any reasonable loading. Another completely unique memory foam developed by Dynamic Systems, Inc. is Pudgee foam.

Pudgee, Sunmate, and Laminar are made with 30% to 50% natural plant material. All other chemicals are vetted for minimum toxicity, making Dynamic Systems Inc. cushions one of the “greenest” foams available in the world.

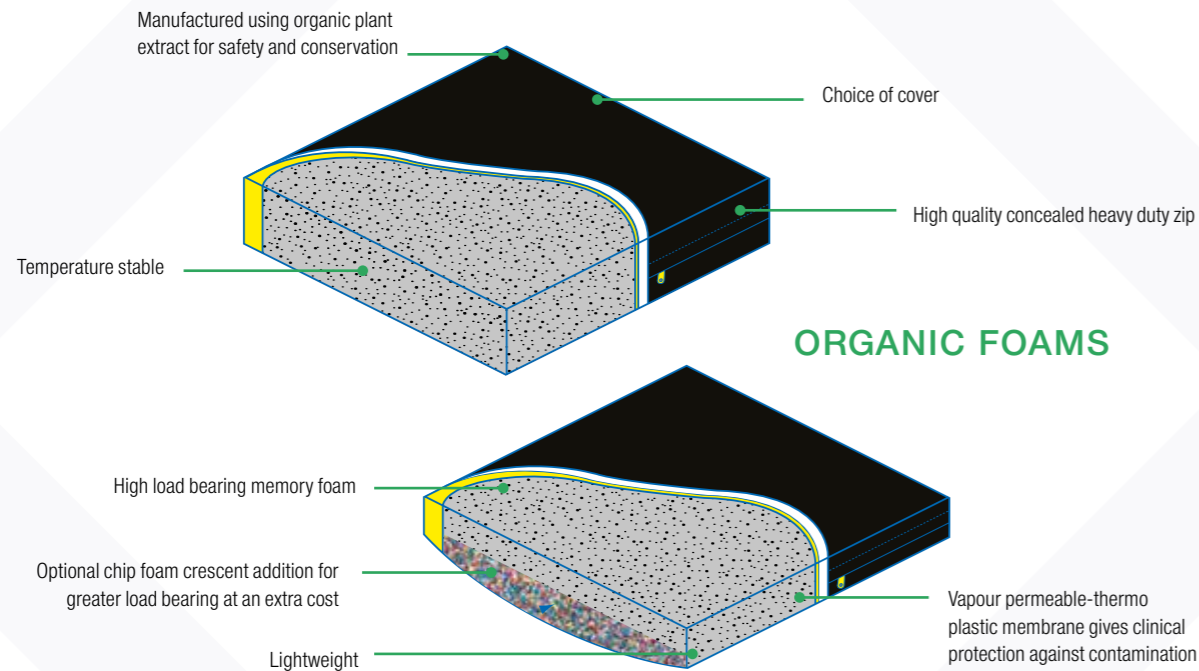

SUNMATE

Manufactured using organic material from renewable and sustainable resources and low or toxic free chemical ingredients. Sunmate is a technically advanced memory foam with unique qualities; it is high load bearing, light in weight and temperature stable whilst remaining soft to the touch. It gently forms around the bony prominences to cushion, protect and support.

The unique formulation reduces and absorbs most everyday transit shocks by up to 90% and has excellent pressure distribution due to its moulding capabilities and reduces common peak pressure areas. Supplied with both vapour permeable thermo plastic liner and an outer cover.

Sizes:	Up to 18" x 18". All cushions are available 1", 2", 3" and 4" thickness. Custom-made shapes and sizes available (eg. wedged or ramped). Larger sizes available POA
Cover:	Vapour permeable cover as standard, towelling material on request, vapour permeable thermo plastic liner. All relevant technical, directional and care information is clearly printed on the rear of the cover
Risk Category*:	Very High
Foam Insert:	Solid memory foam
Weight Guide†:	For maximum comfort, durability and performance the weight guide on a 17"x17" is: 1" Sunmate - 5 Stone (32kg) / 2" Sunmate - 15 Stone (95kg) 3" Sunmate - 18 Stone (114kg)
Support Pressure:	2" Sunmate - 1 ¼ lb per square inch at 50% compression or deflection 3" Sunmate - 1 ½ lb per square inch at 50% compression or deflection
Linear Load Limit:	2" Sunmate - 29 stone (184kg) on a typical 17"x17 cushion 3" Sunmate - 31 stone (197kg) on a typical 17"x17 cushion

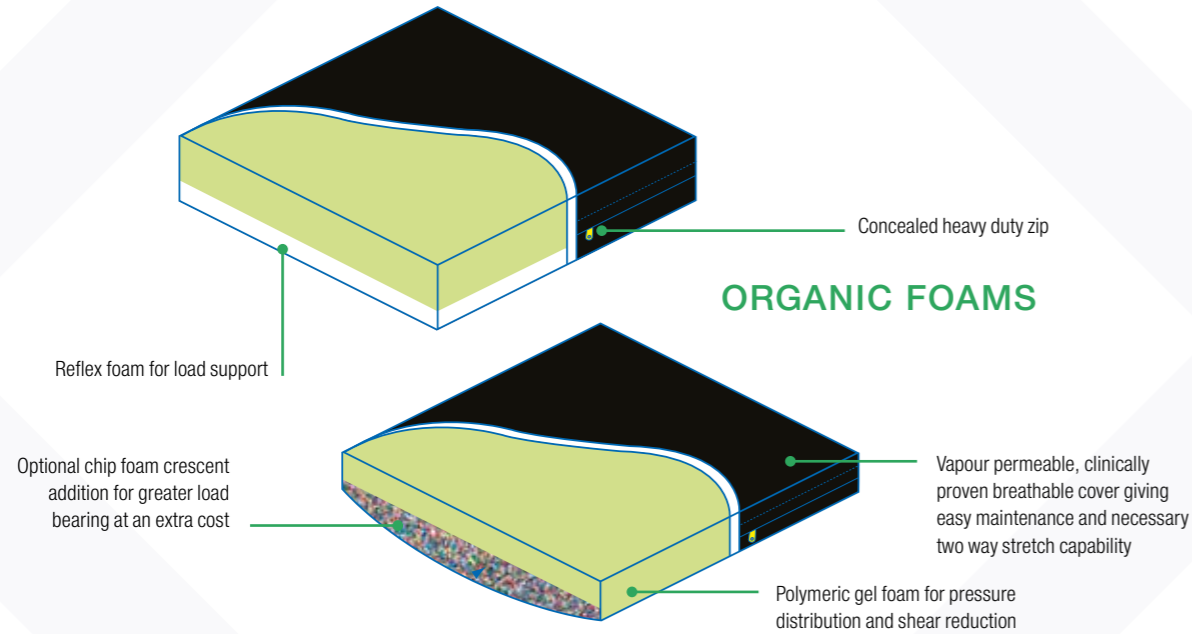

PUDGEE

A unique load distributing foam supported by a high grade Reflex Foam, and finished with a thin layer of comfort foam providing a natural thermal break. Comes as standard with a vapour permeable thermo plastic liner for extra protection and extended durability.

Sizes:	Up to 18" x 18". All cushions are available 1", 2", 3" and 4" thickness. Custom-made shapes available (eg. wedged, ramped or crescent base). Larger sizes available POA. Of particular interest to those designing high risk individual applications
Cover:	Vapour permeable cover as standard, towelling material on request, vapour permeable thermo plastic liner All relevant technical, directional and care information is clearly printed on the rear of the cover
Risk Category*:	Very High
Foam Insert:	Of multi-layer construction. Typical 3" cushion consists of 2", high performance Pudgee foam, supported by 'A' grade reflex foam to improve load bearing and comfort capabilities. Topped off with a thin layer of soft comfort foam
Weight Guide†:	For maximum comfort, durability and performance the weight guide on a 17" x 17" is: 2" Pudgee – 12 Stone (76kg) / 3" Pudgee 15 Stone (95kg)
Support Pressure:	1lb per square inch at 50% compression or deflection
Linear Load Limit:	2" Pudgee – 21stone (133kg) on a typical 17"x17" cushion 3" Pudgee – 29stone (184kg) on a typical 17"x17" cushion

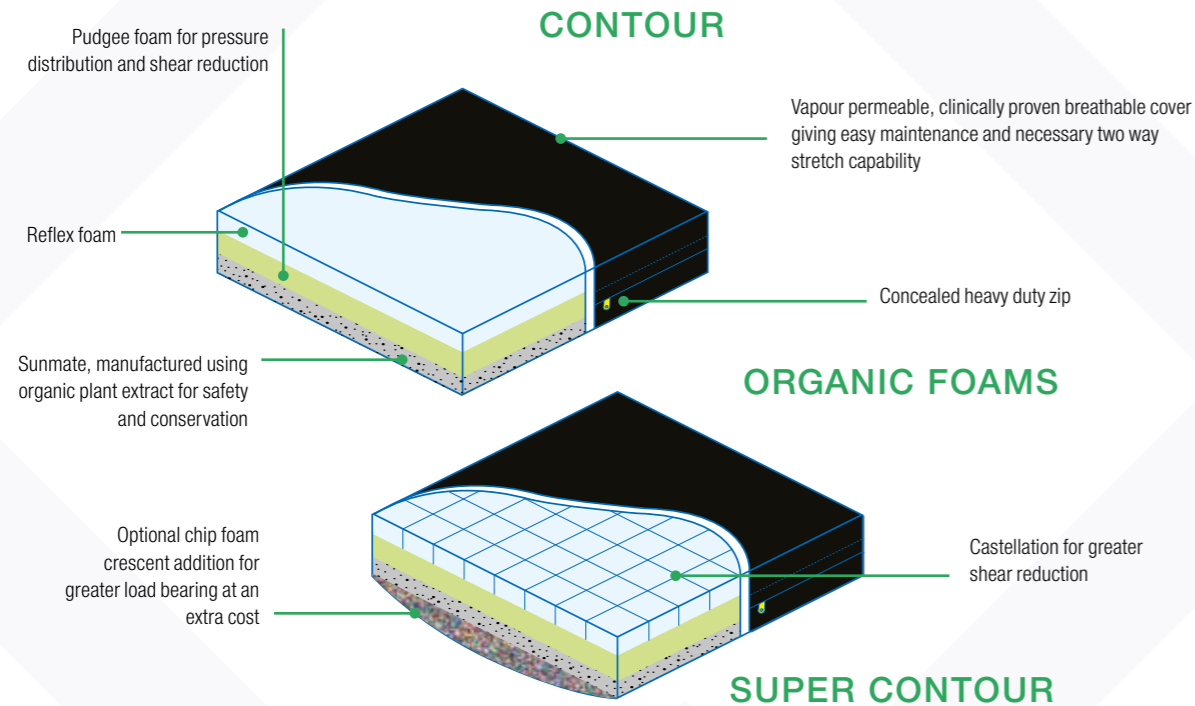

CONTOUR & SUPER CONTOUR

Contours and Super Contours are laminated using three specific types of foam. The base foam of Sunmate, chosen for its unique ability in the viscous foam world of being low memory and high load bearing, high shock absorption while remaining both light and durable.

Pudgee being the second layer, a polymer gel, this is the ultimate in low memory foams giving excellent weight distribution and minimising shearing forces while keeping skin tissue cool. Topped with a soft layer of reflex foam to give that ultra comfort and to provide a thermal break. The Super Contour goes one step better, and castellates this layer to further enhance its shear reduction capabilities. It's this attention to detail that makes Contour and the Super Contour the masters of their type. High load bearing low profile, relatively light weight and yet comfortable and durable. Rated up to very high risk categories it is aimed at the client in the high risk category with a problem compounded by weight.

Sizes:	Up to 18"x18". All cushions are 3" in thickness. Custom-made shapes and sizes available (eg. wedged or ramped). Larger sizes available POA
Cover:	Vapour permeable cover as standard, towelling material on request, vapour permeable thermo plastic liner All relevant technical, directional and care information is clearly printed on the rear of the cover
Risk Category*:	Very High
Foam Insert:	Multi layer, temperature stable, low memory foam. Excellent pressure distribution and shear reduction
Weight Guide†:	For maximum comfort, durability and performance the weight guide on a 17" x 17" is 20 stone (127kg). Can be custom-made for up to 70-80 stone (445-508kg)
Support Pressure:	1¾ lb per square inch at 50% compression or deflection
Linear Load Limit:	36 stone (229kg) on a typical 17"x17" cushion

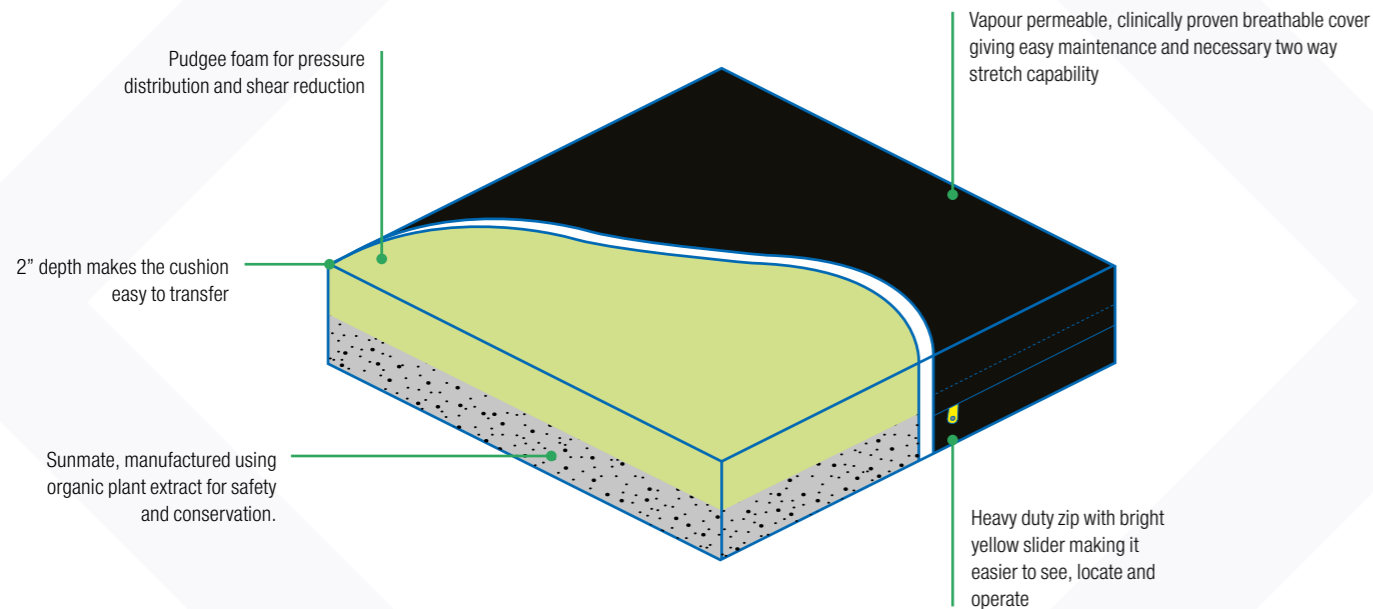

Very High
Risk

LAMINAR

Laminar is laminated using two specific types of foam. The base foam of Sunmate, chosen for its unique ability in the viscous foam world of being low memory and high load bearing, high shock absorption while remaining both light and durable.

Pudgee being the second layer, a polymer gel, this is the ultimate in low memory foams giving excellent weight distribution and minimising shearing forces while keeping skin tissue cool. At only 2" thick, the Laminar carries a high load and is easy to transfer from.

The Laminar comes as standard with a vapour permeable cover.

Sizes:	Up to 18"x18". All cushions are 3" in thickness. Custom-made shapes and sizes available (eg. wedged or ramped). Larger sizes available POA
Cover:	Vapour permeable cover as standard, towelling material on request, vapour permeable thermo plastic liner All relevant technical, directional and care information is clearly printed on the rear of the cover
Risk Category*:	Very High
Foam Insert:	Multi layer, temperature stable, low memory foam. Excellent pressure distribution and shear reduction
Weight Guide†:	For maximum comfort, durability and performance the weight guide on a 17" x 17" is 20 stone (127kg). Can be custom-made for up to 70–80 stone (445–508kg)
Support Pressure:	1¾ lb per square inch at 50% compression or deflection
Linear Load Limit:	36 stone (229kg) on a typical 17"x17" cushion

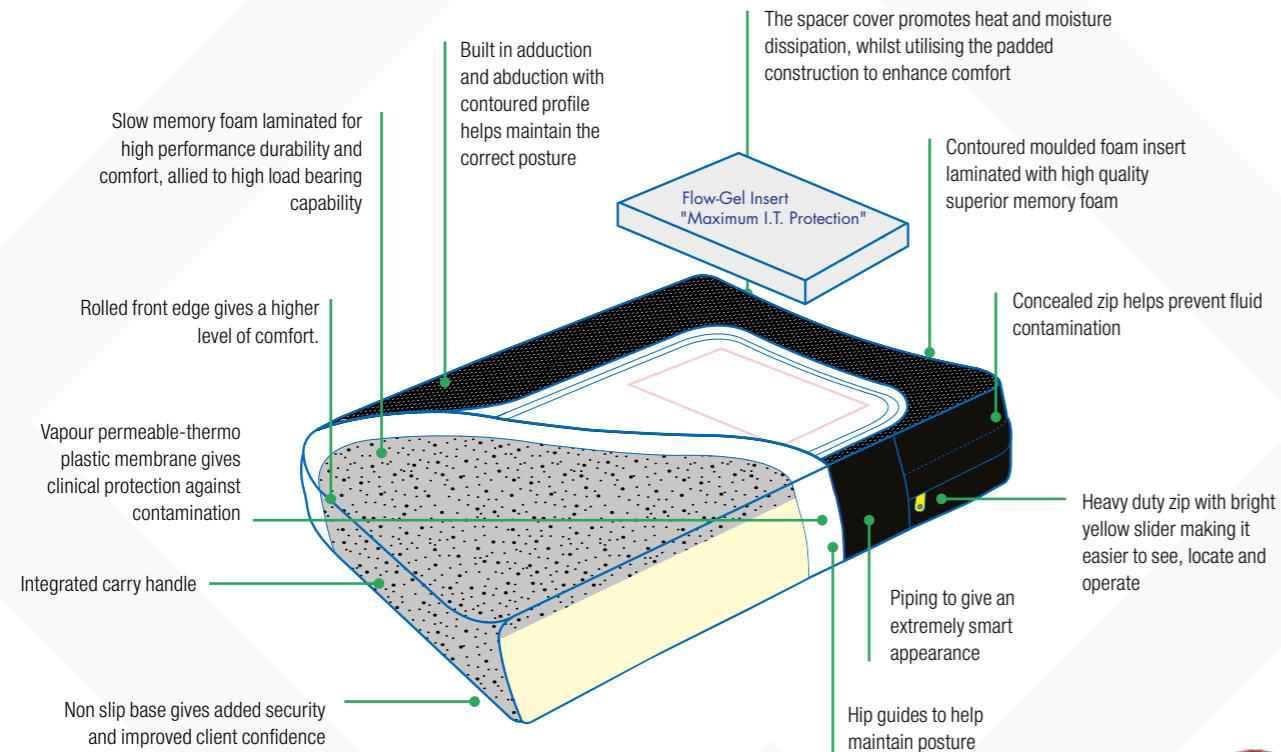

Very High Risk

INTERUM

The latest version of the Qbitus Interum seating component incorporates a completely new support profile for greater comfort, security and positional control and uses an amalgamation of the latest technology available in the field of memory foam and Flow-gel cushion products.

The Qbitus Interum's support layer has been re-shaped with a more acute and aggressively dynamic profile to give a greater degree of posture control and to encourage a higher degree of immersion. A fast reacting Flow-gel insert is located in the I.T area to give maximum protection in these vulnerable and at risk areas, with a final layer using one of the leading memory foams available. This gives excellent protection over the entire working surface, providing both comfort and safety to the client over long periods of use.

Sizes:	Up to 18"x18". All cushions are 4¾" in thickness. Larger sizes available (flat or crescent base)
Cover:	A spacer cover is issued as standard equipment, chosen for its superior heat and Moisture dissipation and bringing with it a high degree of comfort, trimmed with piping and vapour permeable side banding, constructed on a non slip base for added security and incorporating a high visibility quality zip and slider, concealed for increased clinical performance. A vapour permeable thermo plastic interliner is included as standard. All relevant technical, directional and care information is clearly printed on the rear of the main cover
Risk Category*:	Very High
Foam Insert:	Constructed from carefully selected performance foams, chosen for their specific properties. A cold cured moulded base selected for its durability, control and comfort, (used extensively in the automotive industry for that reason) overlaid with Sunmate memory foam, recognised along with Pudgee as the worlds leading memory foam, which unlike other memory foams available (viscous-elastic) is temperature stable and is uniquely load bearing while maintaining its softness to give excellent comfort and long term support
Weight Guide†:	For maximum comfort, durability and performance the weight guide on a 17" x 17" is 18 stone (114kg)
Support Pressure:	1½ lbs per square inch at 50% compression or deflection
Linear Load Limit:	31 stone (197kg) on a typical 17"x17" cushion

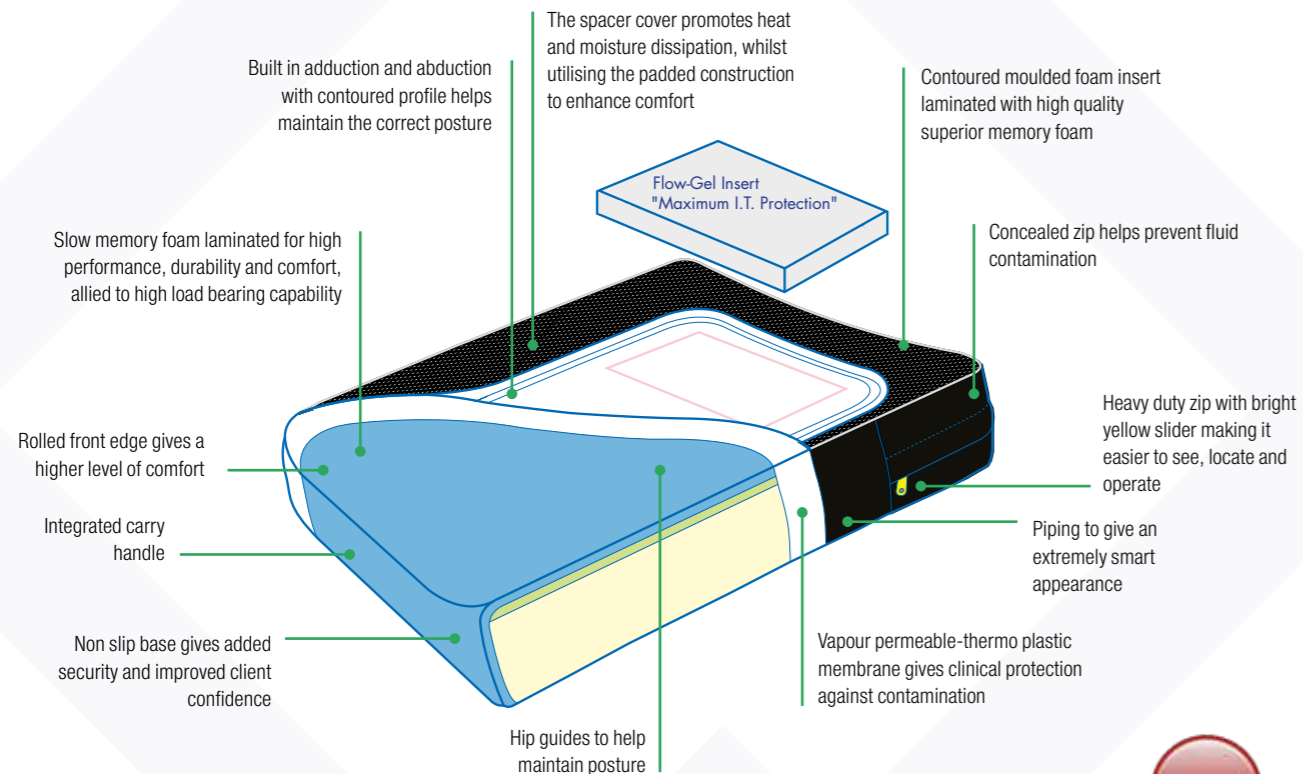

Very High
Risk

OPTIMUS

The Optimus is designed for the very high risk client. As with the previous model of the Optimus it is a step up from the Interum, utilizing the same basic design criteria.

However the Optimus marries Flow-gel technology with polymeric gel foam. This marriage of components provides for an ultimate combination of reactionary capabilities to any given shape. This provides optimum protection, comfort and enhanced control.

Sizes:	Up to 18" x 18". All cushions are 4¾" in thickness. Larger sizes available (flat or crescent based)
Cover:	A spacer cover is issued as standard equipment, chosen for its superior heat and moisture dissipation and bringing with it a high degree of comfort, trimmed with piping and vapour permeable side banding, constructed on a non slip base for added security and incorporating a high visibility quality zip and slider, concealed for increased clinical performance. A vapour permeable thermo plastic interliner is clearly printed on the rear of the main cover
Risk Category*:	Very High
Foam Insert:	A low profile moulded and laminated construction using a triple layer of materials that are combined to provide the ultimate in fit, pressure distribution and the reduction of shearing forces
Weight Guide†:	For maximum comfort, durability and performance the weight guide on a 17" x 17" is 18 stone (114kg)
Support Pressure:	1½ lbs per square inch at 50% compression or deflection
Linear Load Limit:	31 stone (197kg) on a typical 17"x17" cushion

GENERAL SEATING COMPONENTS

BESPOKE & MISCELLANEOUS

Qbitus Products, as the UK's largest supplier of bespoke medical cushions to the NHS are a renowned manufacturer who are able to provide you with a fast and efficient service manufacturing tailor made versions of the Qbitus Product range. Alternatively, constructing cushions, back rests and positional items to your own specific design diagrams or instructions to meet your clients individual needs.

Examples of products such as replacement cover for Qbitus or other manufacturers cushioning, standard or bespoke armrests, T-rolls, wedges, harnessing for all sizes and age groups are readily available.

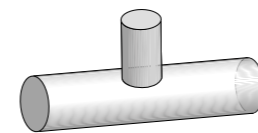

T-ROLL

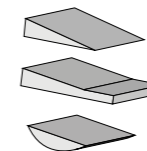

WEDGE/RAMP CUSHION
CRESENT

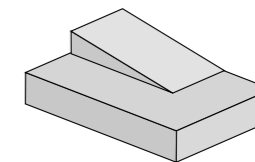

OBLIQUITY
CUSHION

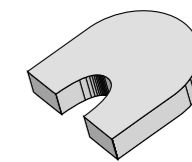

URINAL
CUSHION

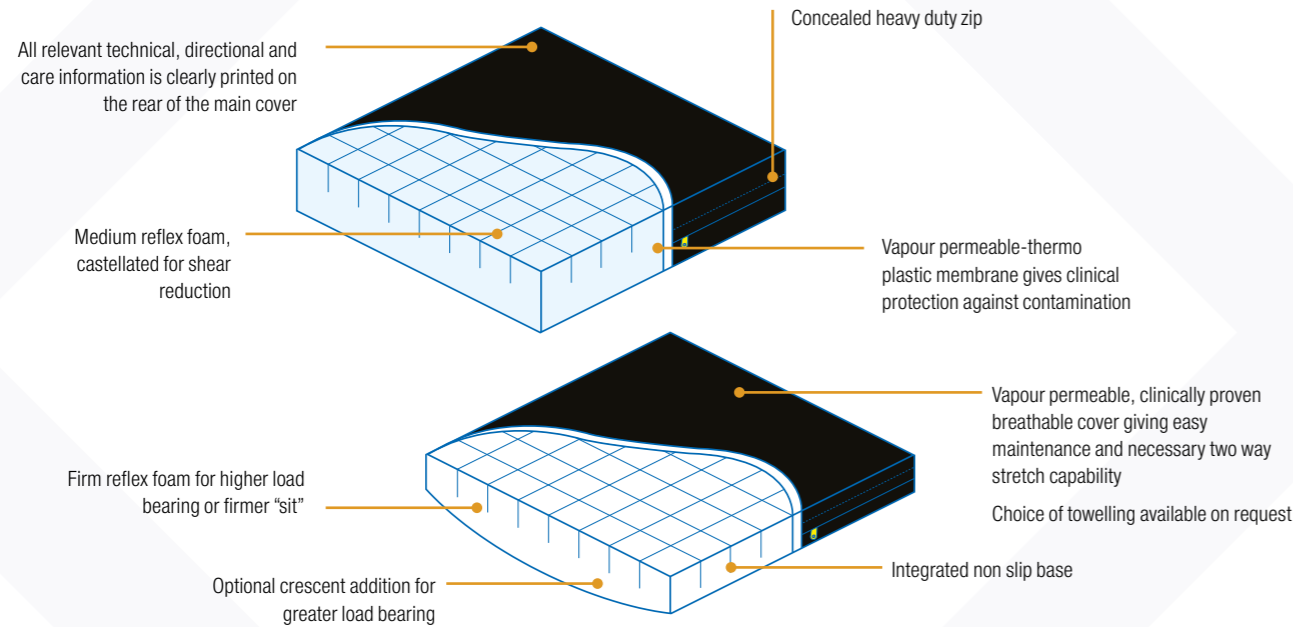

CASTLE-TOPS

Constructed in either high grade RX39 (med) or CM60 (firm)

The Castle-Top range have a flat base. The Castle-Top Plus versions have an integral crescent to take up any canvas sag.

Sizes:	Up to 18"x18". Castle-Top is 3" in thickness. Castle-Top Plus is 3½" (2" + 1½" crescent). Larger sizes available POA
Cover:	Vapour permeable material for convenience. Each cover is equipped with a highly visible heavy duty zip and a vapour permeable thermo plastic liner for extra protection, both finished off with a non slip base for added security. All relevant safety and maintenance information screen printed on the rear of the cover
Risk Category*:	At Risk
Foam Insert:	High grade modern reflex foams, either RX39 or CM60 depending on suitability This is chosen for its reliability. Castle-Top with flat base. Castle-Top Plus with crescent base
Weight Guide†:	For maximum comfort, durability and performance the weight guide on a 17" x 17" is: S46 – Castle-Top (med) – 16 Stone (102kg) S45 – Castle-Top (firm) – 20 Stone (127kg) S44 – Castle-Top Plus (med) – 16 Stone (102kg) S43 – Castle-Top Plus (firm) – 20 Stone (127kg)
Support Pressure:	Med – 1¼ lb per square inch at 50% compression or deflection Firm – 1½ lb per square inch at 50% compression or deflection
Linear Load Limit:	Med – 31 stone (197kg) on a typical 17"x17" cushion Firm – 31 stone (197kg) on a typical 17"x17" cushion

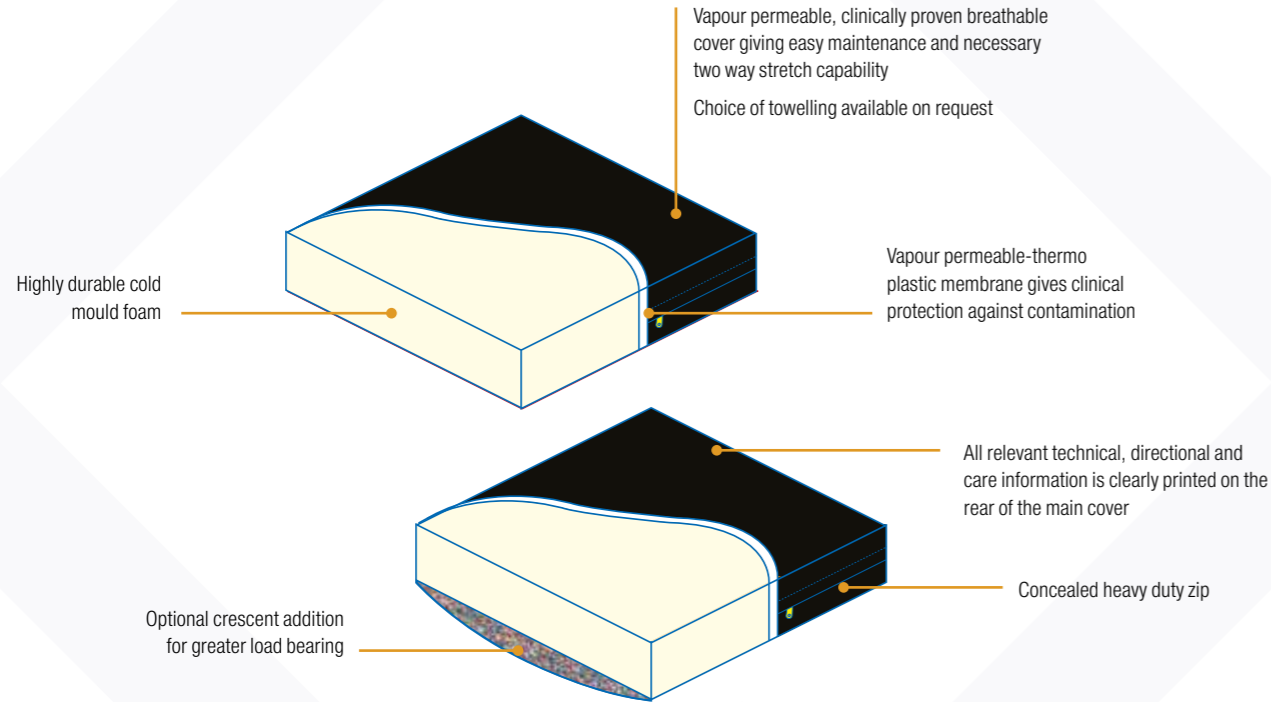

COLD MOULD

A high quality and very durable foam insert manufactured to your specific size. Finished with the cover of your choice. Includes vapour permeable, thermo plastic liner.

Sizes: Up to 18"x18". Larger sizes available POA. (flat or crescent base). Thicknesses – 2", 3", 4" (others on request).

Cover: Vapour permeable cover as standard, towelling material on request, vapour permeable thermo plastic liner. All relevant technical, directional and care information is clearly printed on the rear of the cover.

Risk Category*: High

Foam Insert: High grade modern foam (used extensively in the automotive field for its comfort and durability).

Weight Guide†: For maximum comfort, durability and performance the weight guide on a 17" x 17" is:
2" – 13 stone (83kg) | 3" – 15 stone (95kg) | 4" – 18 stone (114kg)

Support Pressure: 1 lb per square inch at 50% compression or deflection

Linear Load Limit:
2" – 21 stone (133kg) on a typical 17"x17" cushion
3" – 23 stone (146kg) on a typical 17"x17" cushion
4" – 24 stone (152kg) on a typical 17"x17" cushion

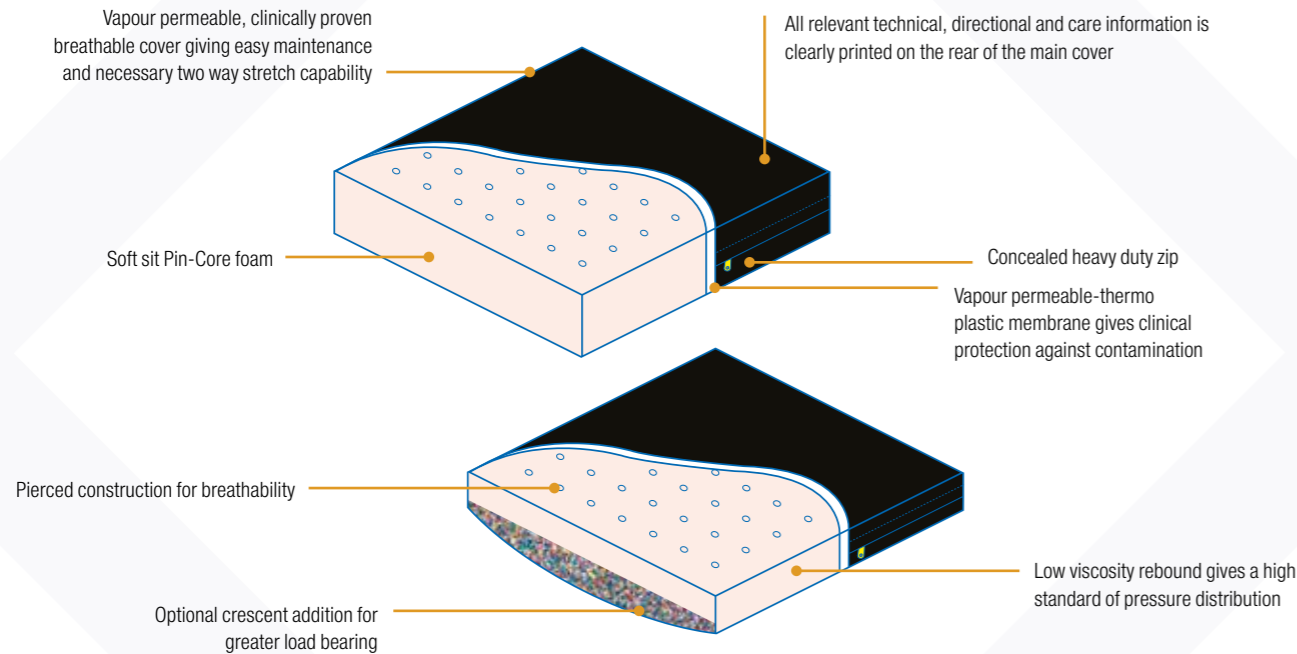

PIN-CORE

An extremely comfortable product with good air circulation, giving exceptional heat and moisture dissipation, which reduces the chance of maceration. Highly recommended and a favourite for the frail and elderly, giving good comfort for general issue and medium risk users.

Sizes:	Up to 18"x18". All cushions are available POA. Thicknesses – 2", 3", 4" (others on request)
Cover:	Vapour permeable cover as standard, towelling material on request, vapour permeable thermo plastic liner All relevant technical, directional and care information is clearly printed on the rear of the cover
Risk Category*:	At Risk
Foam Insert:	A high quality, firm density Pin-Core foam (manmade latex) with built in piercings for better air circulation and greater long term comfort.
Weight Guide†:	Adding a crescent base allows approximately 30% increase in load bearing For maximum comfort, durability and performance the weight guide on a 17" x 17" is: 2" Pincore – 8 Stone (51kg) 3" Pincore – 12 Stone (76kg) 4" Pincore – 14 Stone (89kg)
Support Pressure:	¾ lb per square inch at 50% compression or deflection
Linear Load Limit:	2" – 12stone (76kg) on a typical 17"x17" cushion 3" – 14stone (89kg) on a typical 17"x17" cushion 4" – 16stone (102kg) on a typical 17"x17" cushion Crescent base – 19stone (121kg) on a typical 17"x17" cushion

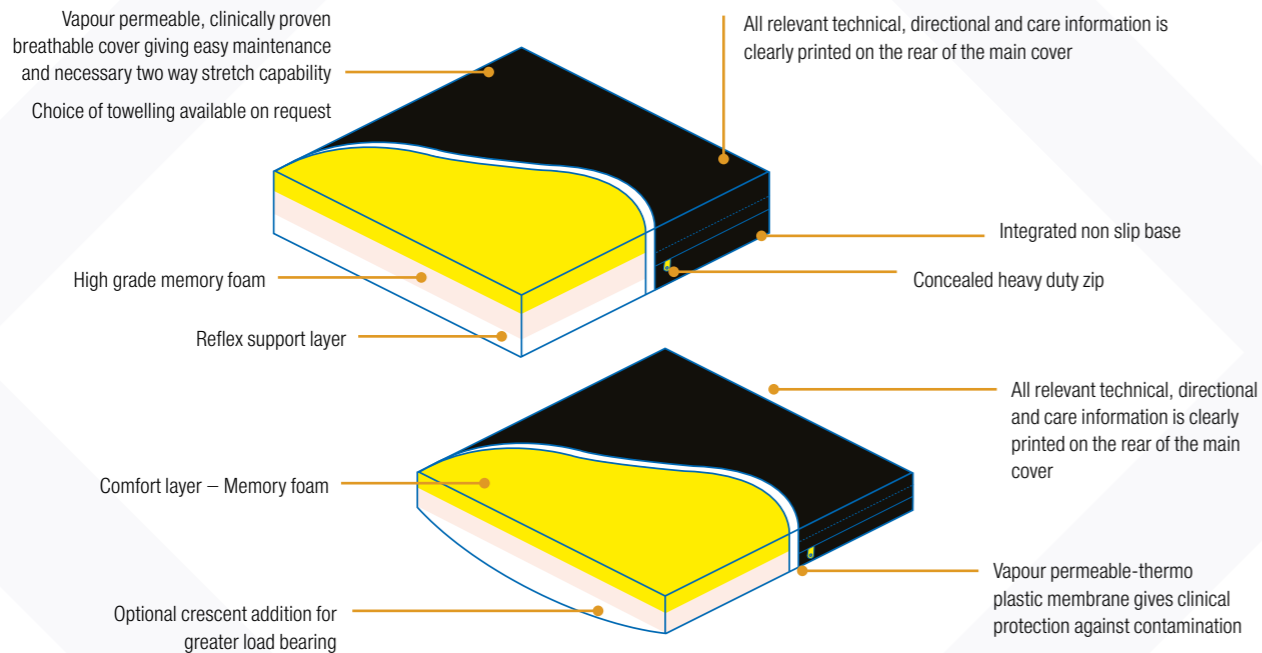

QBI-FLEX

A linear, high performance, cost effective memory foam product giving excellent pressure distribution and comfort. Constructed of three layers: a 1" reflex load bearing foam, 1" of high density memory foam, topped with 1" soft viscous foam for increased comfort.

Sizes:	Up to 18"x18", minimum 3" thickness. Larger sizes available POA
Cover:	Vapour permeable cover as standard, towelling material on request, vapour permeable thermo plastic liner. All relevant technical, directional and care information is clearly printed on the rear of the cover
Risk Category*:	High
Foam Insert:	A directional, multi layer memory and reflex foam lamination
Weight Guide†:	For maximum comfort, durability and performance the weight guide on a 17" x 17" is 15 Stone (95kg)
Support Pressure:	1 lb per square inch at 50% compression or deflection
Linear Load Limit:	20 stone (127kg) on a typical 17"x17" cushion

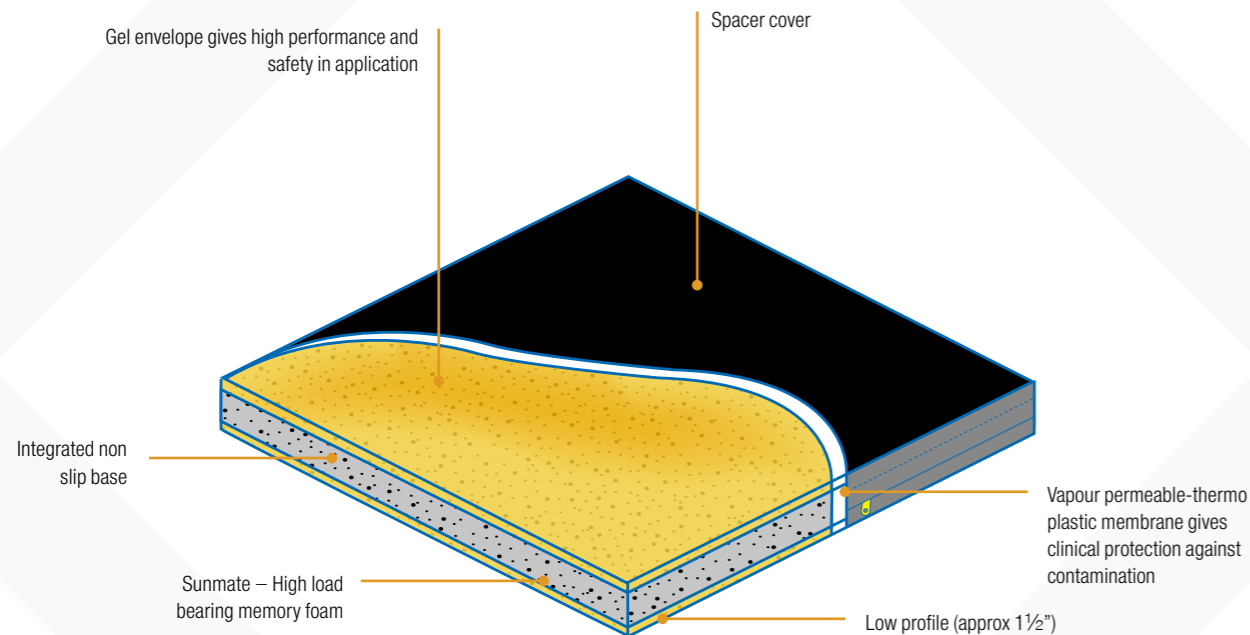

Very High
Risk

QBI-GEL

The Qbi-Gel is an extremely comfortable, low profile, very high risk cushion. It has a safety feature of being multi directional, and comes complete with a specialised cover which helps dissipate heat and moisture using natural ventilation. Recommended for clients who would not normally accommodate a gel product.

It is a multi layered cushion constructed from Sunmate, a leading memory foam, with an envelope of hi tech gel. This provides excellent pressure distribution properties and shear reduction necessary for high risk client care. The Qbi-Gel is an extremely low-profile product (typically 1") which has little effect on the wheelchair seating aspect, therefore not inhibiting the transferral process. It also comes complete with a non slip base and an inner thermo plastic vapour permeable liner.

Sizes:	The Qbi-Gel comes in 16"x16", 17"x17", 18"x16", 18"x17" and 20"x18" only. All cushions are 1 1/2" in thickness
Cover:	Hi tech spacer material which gives excellent air circulation and comfort complete with a non slip base, heavy duty concealed zip and slider, with an inner thermo plastic vapour permeable liner
Risk Category*:	Very High
Foam Insert:	High grade Sunmate memory foam, enveloped in gel
Weight Guide†:	For maximum comfort, durability and performance the weight guide on a 17" x 17" is 30 Stone (191kg)
Support Pressure:	1 3/4 lbs per square inch at 50% compression or deflection
Linear Load Limit:	34 stone (216kg) on a typical 17"x17" cushion

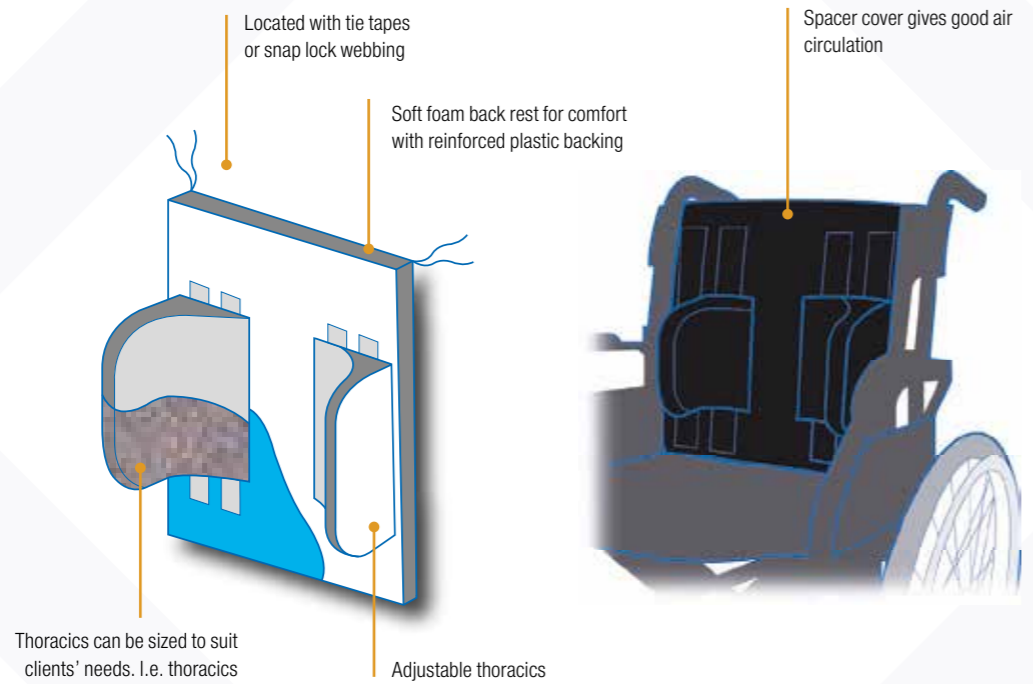

LATERAL SUPPORT SYSTEM

The back cushion is constructed of 1" RX39, comfort foam, backed with 1mm ABS plastic for flexibility and Lateral rigidity. The thoracics are constructed from A grade 8lb chip foam for strength and comfort.

The Lateral Support System consists of a Velcro faced backrest, which has an integral stiffener and two Velcro attached thoracic supports. The unique contour of the thoracic pads ensures a snug fit to assist the user's posture when they lean back into the chair. Correct alignment is achieved by adjusting pad position to suit the user's needs. Unequal pad sizes can be supplied.

Sizes:	Any Size Available
Cover:	Black spacer cover as standard. All are removable with a zip. Other covers such as vapour permeable material can be specified.
Application:	To give a low/medium amount of assistance and support.

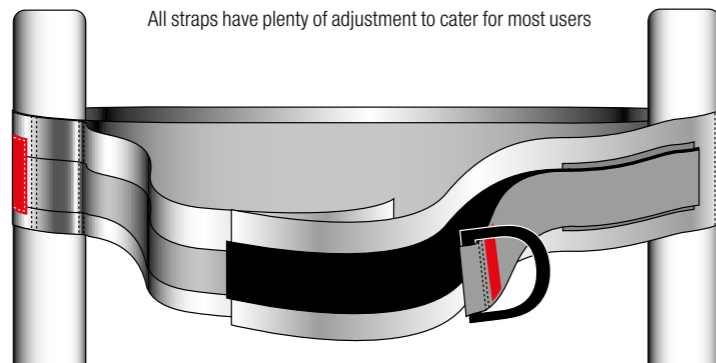

THIS FIGURE OF EIGHT STYLE CHEST STRAP WILL FASTEN SECURELY AROUND THE CHAIR AND THE USER, WITH INDEPENDENT CONTROL, TO ENSURE SAFETY, SECURITY AND COMFORT. WILL FIT MANY TYPES OF CHAIR

HALIFAX CHEST STRAP

The Halifax Chest Strap has a safety overlap which enables the carer to ensure greater security if required, and twin belt loops to reduce the chance of the Chest Strap slipping down.

Chest Sizes:
 34" - 36" (86 – 92cm) Small
 38" – 40" (96 – 100cm) Medium
 42" – 44" (106 – 112cm) Large

USER INSTRUCTIONS:

1. Fasten the coloured loop section around the chair securely
2. Seat the user/wearer into the chair and fasten the remaining loop around the chest ensuring comfort
3. If the wearer is not at risk from falling out of the chair – leave the "D" ring section attached to the front of the strap
4. If the wearer is considered at risk of falling out of the chair – detach the "D" ring section and secure around the back of the chair for extra security

WASHING/ CLEANING Sponge with hot water or machine wash at 60° – do not bleach
 Take special care if wearer is prone to "submarining".

Linear Load Limit: 34 stone (216kg) on a typical 17"x17" cushion

DO NOT USE AS THE PRIMARY MEANS OF SECURITY WHILST USER IS BEING TRANSPORTED IN A VEHICLE

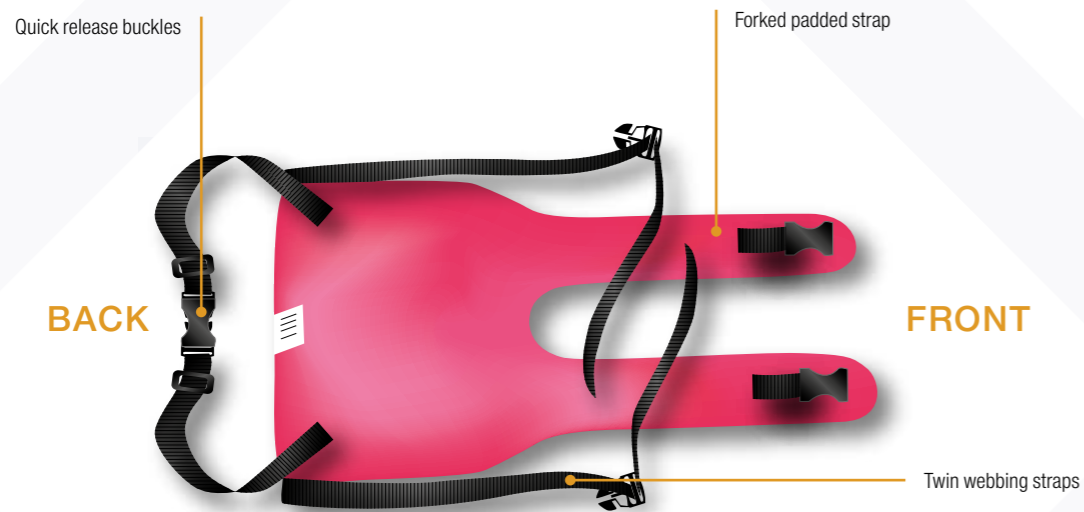

**PLEASE NOTE:
THIS PRODUCT SHOULD BE USED UNDER SUPERVISION
AFTER CLINICAL ASSESSMENT.**

HALIFAX GROIN HARNESS

The Halifax Groin Harness provides excellent control of extensor thrust and adductor spasm, it also helps to prevent the user sliding forward. The harness can be used in conjunction with our Qbitus lap strap providing a more stable base for the pelvis.

USER INSTRUCTIONS:

1. Place harness on chair with buckles on the padded forked straps underneath.
2. Anchor the cushioned area of the Halifax groin harness to the chair with the twin webbing straps and buckle.
3. Seat the user on the cushion, the forked padded straps are then passed between the legs and brought up and over the thighs and then locked by the quick release buckles attached to the rear of the chair, checking for fit and comfort of the client.

NB. These items should be fitted under clinical supervision. Locating points may differ on various wheelchairs.

FRONT BIB STYLE

24" - 28" Chest

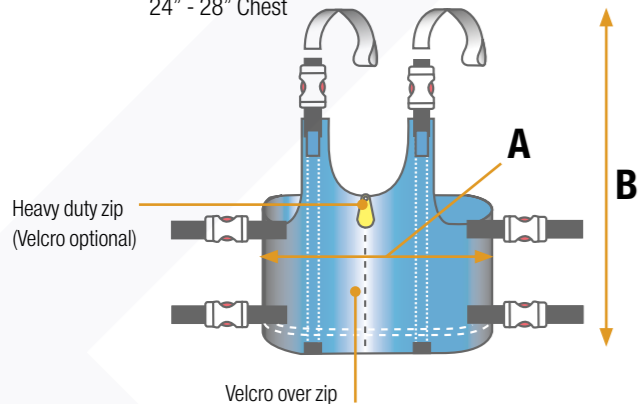

FULL JACKET WITH GROIN STRAP

24" - 28" Chest

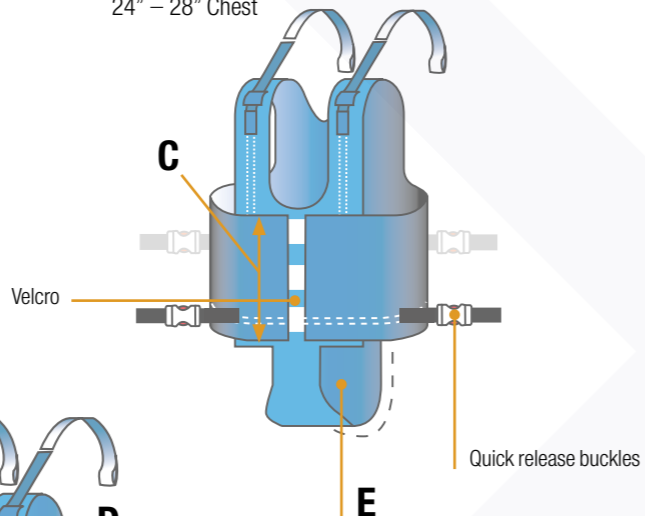

FULL JACKET STYLE

24" - 28" Chest

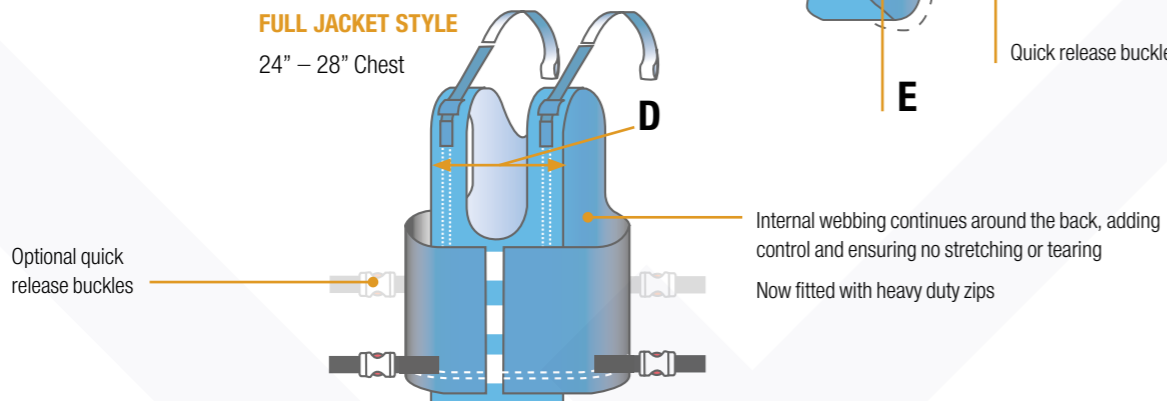

WAISTCOAT HARNESSES & MEASUREMENTS

This update sheet will help ensure correct fitting and safety in use of our QBITUS waistcoat harnesses.

When measuring for a waistcoat please remember that additional outdoor clothing will need to be taken into account, however designs have adequate exibility for adjustment. If you need more adjustability, please specify when ordering.

The chart below requests the critical measurements which are needed, however any other measurements given may be useful when submitting your measurement information.

Chest circumference:	A
Top of shoulder to waist:	B
Under axilla to waist	C
Centre of shoulder to centre shoulder	D
Waist through to rear of waist (for groin strap length)	E

Additional measurement request:

Middle of shoulder to middle of shoulder, this will ensure no strap slippage or chaffing of the neck.

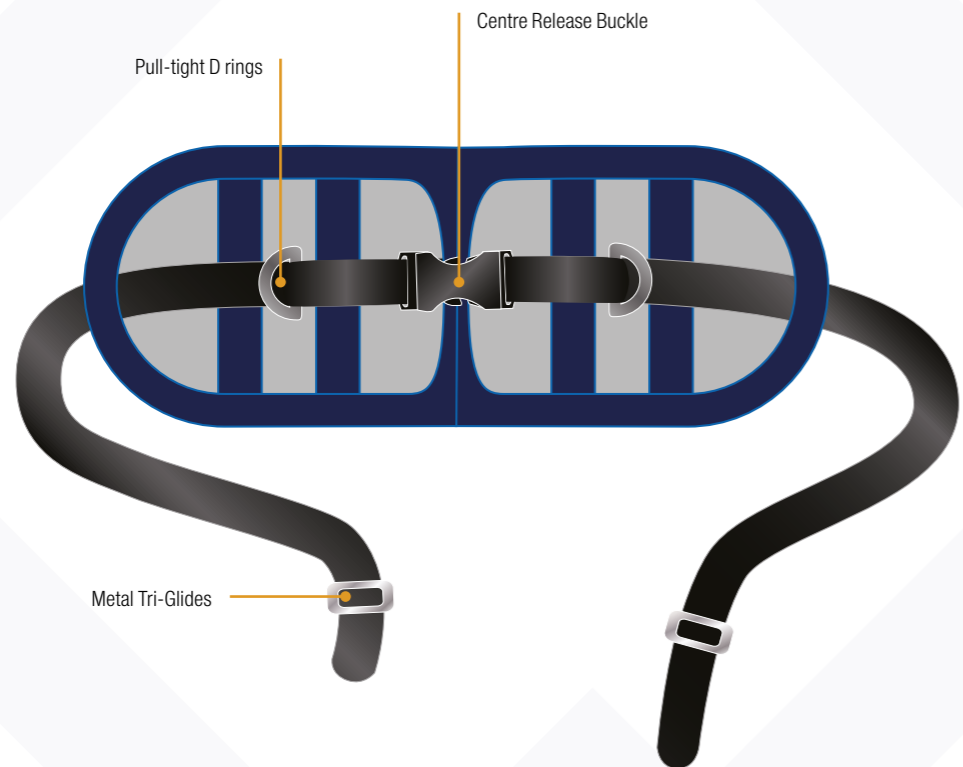

ABERDEEN PADDED PELVIC BELT

The Aberdeen Padded Pelvic Belt is ideal for positioning wheelchair users.

It is padded across the centre section using a durable, comfortable and washable material.

Webbing straps can be adjusted at the front by pulling the D-Rings attached, and there is a centre release buckle for ease of use. Webbing straps have a metal Tri-Glide attached to each end which should be looped around each post and pulled tight.

The material used is high quality webbing, used for seat belts in the automotive industry for its strength and comfort.



CLEANING INSTRUCTIONS

If possible sponge off any spillage and contamination as soon as possible with hot water and soap, or a mild hypochlorite solution can also be used such as Milton if desired, then air dry.

DO NOT MACHINE WASH OR TUMBLE DRY.

These belts should be inspected on a daily basis.

Note: These belts should not be used as primary means of security when using vehicular transport, occupants should be secured by means of a three-point seat belt anchored to the vehicle. These belts must be fitted and used under clinical supervision and after clinical assessment.

LAP STRAP A

Qbitus Lap Straps are ideal for positioning wheelchair users, it is padded across the centre section to provide comfort, more control and achieve a better pull down or pull back. This belt must be used under clinical supervision and after clinical assessment.

One Size to fits all.

Lap Strap A – Product Code: S93

Supplied with: Padded frontal section fitted with side release buckles, two looped and eyeleted attachment straps.

1. Place the strap around the chair back or seat as required, with the securing loops fixed close to the corner of the seat/back. Locating points may differ on various wheelchairs.
2. Adjust the rear buckles so as to centralise the frontal section.
3. Remove screws from rear chair uprights or seat at correct level.
4. Locate these screws through eyeleted loops and refit securely.
5. The belt should rise at approximately 45 degrees to the seat to suit the users pelvis.
6. Seat user with their lower back against the seat back, fasten belt over pelvic area, if necessary re-adjust for control and comfort allowing a two-finger space under belt.
7. The belt can be adjusted by pushing the webbing through the tri-glide and pulling back.
8. A standard belt has a maximum adjustment of 100-150mm once the belt has been adjusted to suit the user.
9. Trim or secure any excess webbing in the interest of safety.
10. The belt should be checked for adjustment at regular intervals throughout the day.



CLEANING INSTRUCTIONS

If possible sponge off any spillage and contamination as soon as possible with hot water and soap, or a mild hypochlorite solution can also be used such as Milton if desired, then air dry.

DO NOT MACHINE WASH OR TUMBLE DRY.

These belts should be inspected on a daily basis.

Note: These belts should not be used as primary means of security when using vehicular transport, occupants should be secured by means of a three-point seat belt anchored to the vehicle. These belts must be fitted and used under clinical supervision and after clinical assessment.

LAP STRAP B

Lap Strap B – Product Code: S94

Supplied with: Padded frontal section fitted with side release buckles, two adjustable detachable axle tilt stub loops.

1. Attach axle tilt loops over tilt stubs and tighten securely, by adjusting tri-glides.
2. Place the strap around the chair back or seat as required, with the securing loops fixed close to the corner of the seat/back. Locating points may differ on various wheelchairs.
3. The belt should rise at approximately 45 degrees to the seat to suit the users pelvis.
4. Attach axle tilt loops to main belt and adjust as required by using the tri-glides.
5. Seat user with their lower back against the seat back, fasten belt over pelvic area, if necessary re-adjust for control and comfort allowing a two-finger space under belt.
6. The belt can be adjusted by pushing the webbing through the tri-glide and pulling back.
7. A standard belt has a maximum adjustment of 100-150mm once the belt has been adjusted to suit the user.
8. Trim or secure any excess webbing in the interest of safety.
9. The belt should be checked for adjustment at regular intervals throughout the day.

UNI-FIT & GUTTER PADDED ARMRESTS

Uni-fit Armrest: S95

This is a simple clip-over design to avoid any chair modifications.

The armrest is padded for better comfort. Provides the ability to reduce chair width if required.

Standard size of the Uni-fit armrest is 12" long x 8" high the space that goes over the chair is 1" wide.

Bespoke sizes available upon request.

UNI-FIT ARMREST

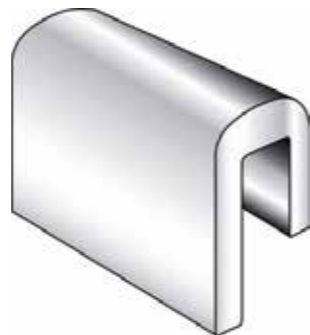

GUTTER PADDED ARMREST

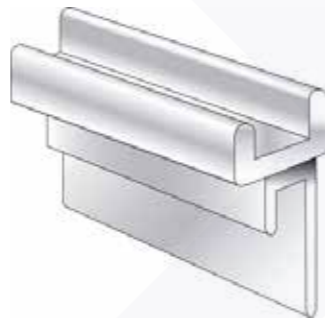

Gutter Padded Armrest: S96

Similar in attachment as the Uni-Fit. The armrest allows the arm to rest in the top section.

Better control of power chairs. Ideal for users with poor arm control.

Hand Paddles also available to rest the palm on.

Standard size of the Gutter armrest is 12" long x 9" high.

Bespoke sizes available upon request.

PU LUMBAR CURVE & CALF STRAP

Pu Lumbar Curve

A mid sized backrest which is designed to cradle the lumbar region. Attached using Velcro and elastic straps, and is available in several sizes.

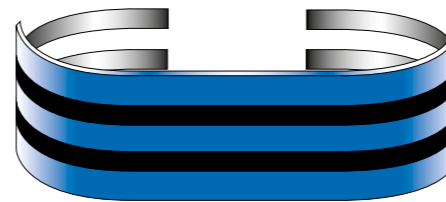
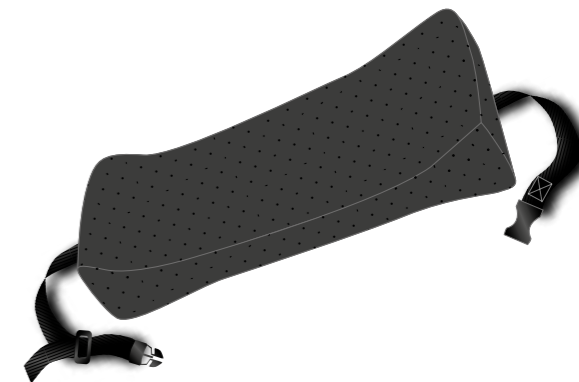

Calf Strap

A range of calf straps to fit all wheelchairs.

There is a choice of material types, designs and methods of attachment.

1" WEDGE



1½" WEDGE



2" WEDGE



LEFT HAND LATERAL SUPPORT

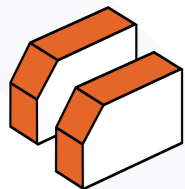

LUMBAR ROLL



ABDUCTOR



FOAM CRESCENT INFILL COMPENSATOR



POMMEL

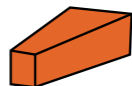

BACK REST

17"X17"X1"

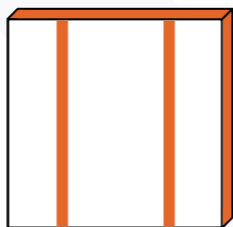

THORACIC SUPPORT

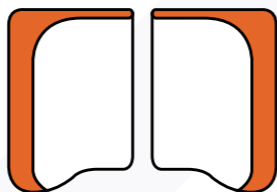

ASSESSMENT KIT

Make life easier with a collection of usefully sized foam cushions, wedges, pommels etc.

All units are fitted with Velcro. Wedges can be stacked to increase the height and the options.

All items in the kit are clearly labelled and covered with a durable fabric.

Additional items may be ordered direct from Qbitus.

INSTRUCTIONS FOR USE & CLEANING

DESIGN

The device has been designed to provide the correct levels of pressure reduction, support and comfort which are needed and according to the design the correct amount of postural assistance.

PLACEMENT

1. Before using the cushion for the first time, please remove the outer packaging if present and check that the chair seat has no objects or projections which may damage the new cushion.
2. Place the device onto the chair ensuring that our label is on the base of the device (i.e.. do not sit or lean on the label side).

CLEANING

The cushion has removable covers and can be cleaned according to the material type. If possible sponge off any spillage or contamination as soon as possible with hot water and soap. Do not remove the special transparent liner (if fitted) but sponge it down.

DOMESTIC CLEANING

All products have an approved cleaning label which you should follow to ensure durability and cleanliness of the product.

ALL WATERPROOF COVERS wipe over with hot water and soap, a mild hypochlorite solution can also be used (Milton) if desired.

Vapour permeable material, towelling and spacer covers can be machine washed at 60 degrees and tumbled dry on warm only. Leave to air dry before refitting. Do not use furniture polish on the cover.

CLEANING INSTITUTIONAL VAPOUR PERMEABLE MATERIAL

Can be washed at 60 degrees Celsius or dry cleaned. Wipe over with full strength Sodium Hypochlorite or Sodium Dichloroisocyanurate and maintain surface contact for 2–5 minutes. Wipe off and rinse with clean water and dry.

DO NOT USE PHENOL BASED PRODUCTS ON ANY WATERPROOF COVER

If MRSA is suspected or confirmed please contact your Infection Control Department for advice.

DO NOT PLACE THE WHOLE DEVICE DIRECTLY INTO A WASHING MACHINE

Direct Healthcare Group

Advancing Movement & Health

About Direct Healthcare Group

When in poor health movement is vital to our recovery and rehabilitation. Being in poor health can dramatically reduce our ability to move, leading to further health complications and slower recovery. If immobilised, either through injury or long term condition, movement is also crucial for maintaining physical independence and mental wellbeing.

Supporting mobility and independence is essential to maintaining good health and helping us recover more quickly from poor health. No-one better understands the importance of movement and its relationship to both physical and mental health than **Direct Healthcare Group**, especially when the need to move directly affects our quality of daily living.

From effective prevention and treatment of pressure ulcers, to supporting challenging care delivery for a broad patient spectrum including those with complex, long term conditions, we support carers and those they provide care for.

Direct Healthcare Group uniquely enables the healthcare challenges associated with reduced patient movement to be anticipated, managed, and in many cases, resolved to support care providers and patients.

All leading to better health outcomes, accelerated recovery and easier daily living.

Direct Healthcare
Services





Qbitus Products

Springwood Cornmill
Rawroyds, Holywell Green
Halifax HX4 9ED

T: +44 (0) 1422 377775

F: +44 (0) 1422 311750

E: sales@qbitus.co.uk

LIT-00043 Issue 1 Date: June 2018

Direct Healthcare Group

Advancing Movement & Health

DIRECTHEALTHCAREGROUP.COM